

Eisele

EISELE **MULTILINE PROGRAM**

MULTIPLE COUPLINGS FOR MULTIPLE MEDIA CONNECTIONS

 QUALITY SOLUTIONS
MADE BY EISELE



MULTI

EISELE IS QUALITY MADE IN GERMANY

Over 30 patents, more than 5,000 standard articles, and 2,000 customized solutions impressively underline our top quality performance. Whether the solution is configured from standard components or individually customized: all EISELE products boast convincing quality, long lifetimes and sophisticated technology.

Our company is loyal to its philosophy and its roots. Germany is the place where we find our highly qualified employees – the workforce responsible for our company's output. With a manufacturing depth of almost 100%, and stock keeping at the production site itself, we can optimally supply our customers, and respond quickly to fulfill needs and technical specifications. EISELE is part of a global logistics network that guarantees the fast availability of our products on the global market.



DIN EN ISO 9001: 2008 – EISELE has been certified since 1994. We have continuously been updating this quality standard and will continue to maintain it with future certifications. The elements of our basic philosophy include sustainable quality, flexibility and continuous improvement.



From EISELE connection components you may expect:

- + Highest tightness and safety
- + Ruggedness and long lifetimes
- + Vacuum-compatible products
- + Easy mounting and disassembly
- + Special connections for a broad range of applications



Content overview		Page	Series
EISELE MULTILINE	 <p>Series 1800 - Multiple couplings without shut-off Economically priced standard coupling with plug connectors - fully mounted delivery</p>	5	1800
	 <p>Series 1811 - Multiple couplings with shut-off Intuitive handling makes the 1811 series our top model</p>	9	1811
	 <p>Series 1870+1871 - Elektro-pneumactical couplings Flexible pneumatic coupling in combination with an electric interface</p>	19	1870+1871
	 <p>Accessories Ideal supplement to the Eisele MULTILINE connections</p>	25	ACC
	 <p>Customised connection solutions Individual customer solutions</p>	31	CLIENT
 <p>Plastic hoses PE, PA, PU, Eisele ProWeld, PTFE/FEP, PVC, NBR</p>	35	99	
Article number index		42	
General terms and conditions		46	

Series overview

EISELE MULTILINE	Series		
	1800	1811	1870 +1871
Compressed air	●	●	●
Fluids* <small>*on request</small>	●		●
Electronic			●
Without shut-off	●	●	
With shut-off		●	●
Intuitive handling		●	●
Positioning pin	●		
Codeable		●	
Interface for hose bundles	●	●	
FPM o-rings	●	●	●
Suitable for vacuum	●	●	●
Push-in connector	●	●	●
Numbered connections	●	●	●
Bulkhead connector	●	●	●

Series 1800 - Multiple couplings without shut-off

1800

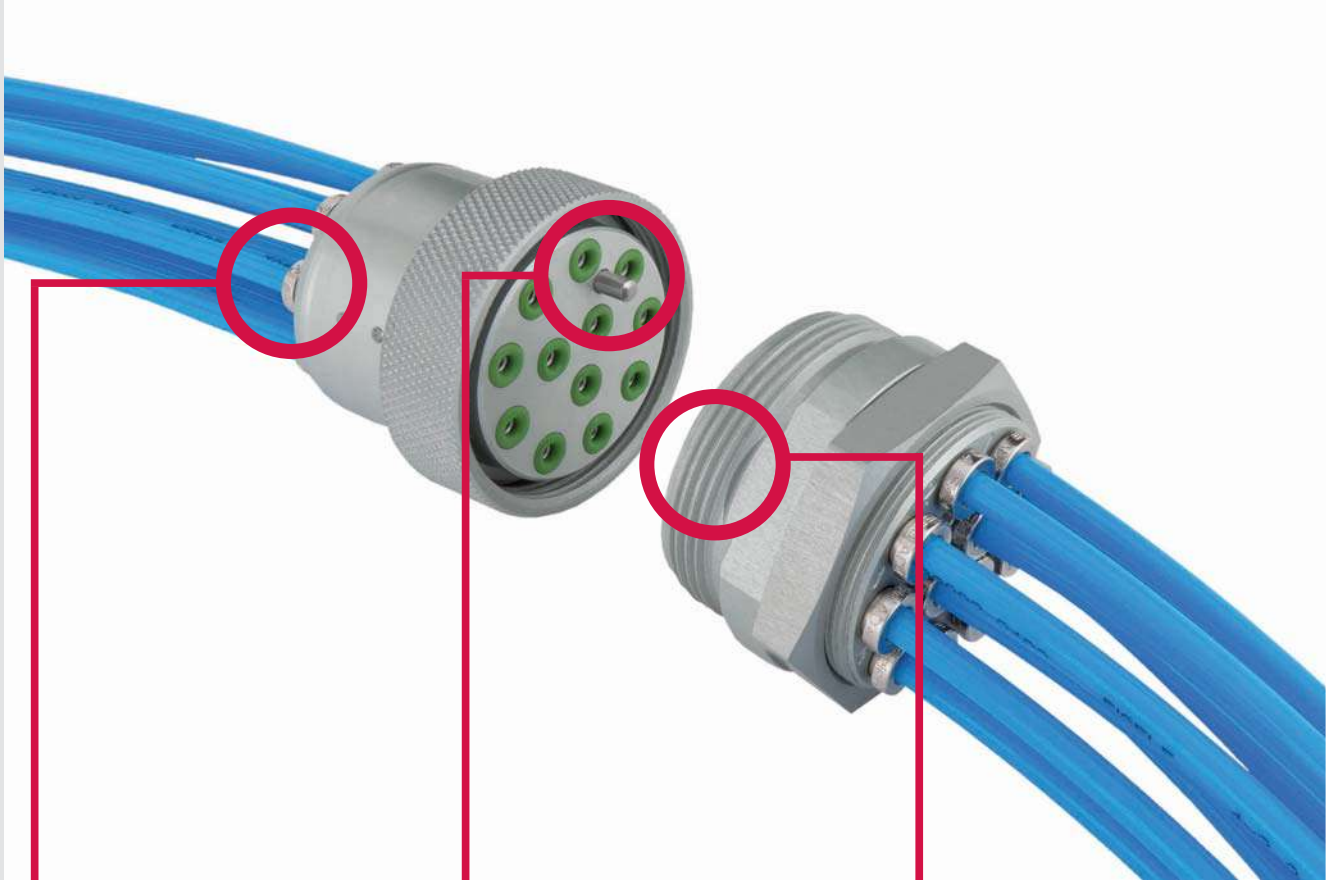

Low Total costs

- Fully mounted delivery
- Quick connection for hose mounting
- Full hose passage

High-quality Processing

- Metal housing
- Made in Germany
- Exclusive design

Time- and Space-saving

- Space-optimized construction
- Patented quick connections
- Assembly errors will be prevented through the use of positioning pins

Functional principle

1800

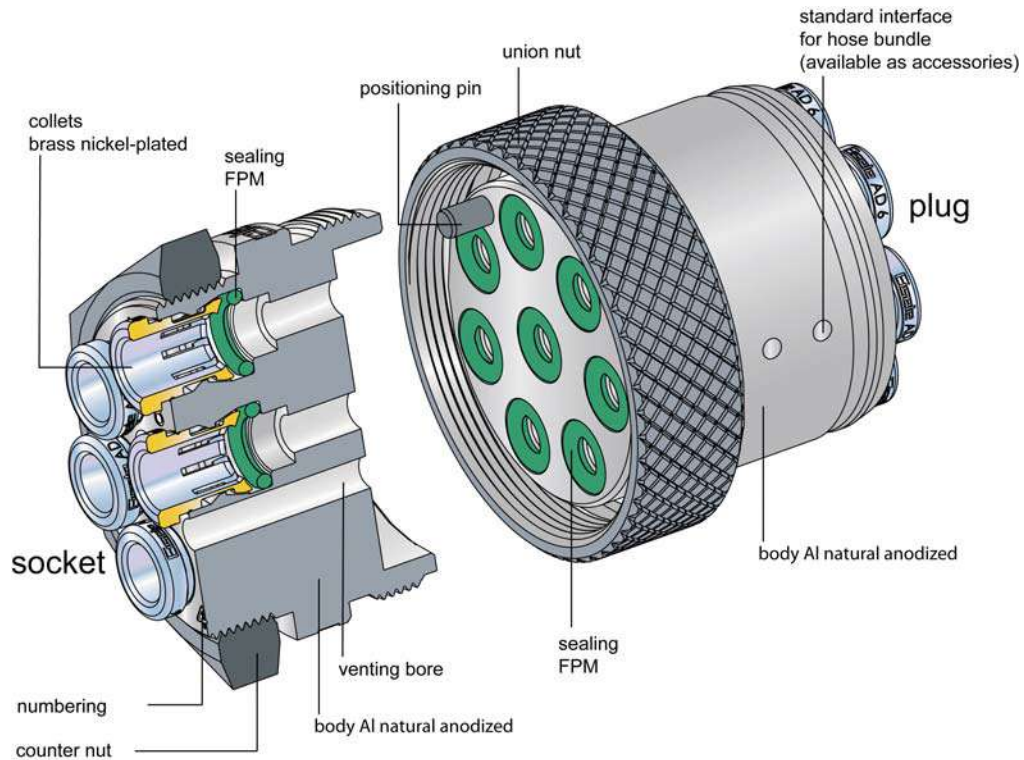

The hoses are inserted into the numbered quick-connect couplings. The hoses are held securely in the housing by the collets. Even after a long period of time, the hoses can be released and re-inserted easily without any damage.

The positioning pin is used to locate the correct position when connecting the coupling. The two halves of the coupling are connected securely using the union nut.

Range of application

- Apparatus engineering
- Mechanical engineering
- Plant engineering

Service conditions

- Temperature range: -20 to +120°C
- Working pressure range -0.95 to 16 bar
- Very fast and easy assembly
- Disassembly without tools possible
- Full hose passage
- Qualified for compressed air
- use with liquids on request

Handling

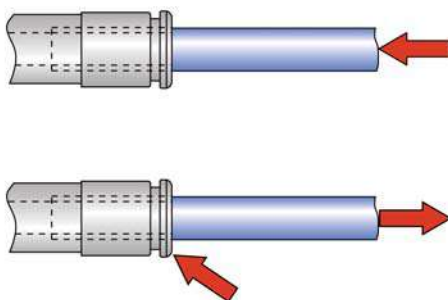

Assembly: Push hose into the connector up to the limit stop

Disassembly: Push release sleeve, pull out hose

Multiple coupling without shut-off

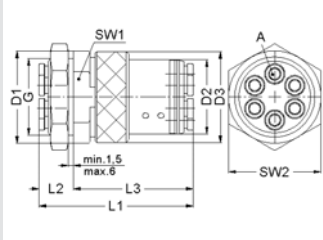

- Plug connectors Series 15
- Can be assembled as bulkhead
- Sealing FPM
- Material Al natural anodized, brass nickel-plated
- Temperature range -20 to +120 °C
- Working pressure range -0.95 to 16 bar

1800

Part no.	Assembly	Design	for hose	L1	L2	L3	G	D1	D2	D3	SW1	SW2	NW	g/piece
VT1800-0402	complete	4-fold	OD4 (4/2)	59	13,5	45,5	M23x1	29	23	30	23	27	2	77
VT1800-040201	socket	4-fold	OD4 (4/2)											11
VT1800-040202	plug	4-fold	OD4 (4/2)											11
VT1800-0404	complete	4-fold	OD6 (6/4)	59	13,5	45,5	M30x1	36	29	35,5	30	36	4	117
VT1800-040401	socket	4-fold	OD6 (6/4)											12
VT1800-040402	plug	4-fold	OD6 (6/4)											12
VT1800-0406	complete	4-fold	OD8 (8/6)	59,5	13,5	46	M36x1	42	36	44	36	40	6	167
VT1800-040601	socket	4-fold	OD8 (8/6)											13
VT1800-040602	plug	4-fold	OD8 (8/6)											13
VT1800-0602	complete	6-fold	OD4 (4/2)	59	13,5	45,5	M30x1	36	29	35,5	30	36	2	116
VT1800-060201	socket	6-fold	OD4 (4/2)											14
VT1800-060202	plug	6-fold	OD4 (4/2)											14
VT1800-0604	complete	6-fold	OD6 (6/4)	59	13,5	45,5	M36x1	42	36	44	36	40	4	170
VT1800-060401	socket	6-fold	OD6 (6/4)											15
VT1800-060402	plug	6-fold	OD6 (6/4)											15
VT1800-0606	complete	6-fold	OD8 (8/6)	59,5	13,5	46	M50x1	55	48	55	50	55	6	295
VT1800-060601	socket	6-fold	OD8 (8/6)											16
VT1800-060602	plug	6-fold	OD8 (8/6)											16
VT1800-0802	complete	8-fold	OD4 (4/2)	59	13,5	45,5	M30x1	36	29	35,5	30	36	2	116
VT1800-080201	socket	8-fold	OD4 (4/2)											17
VT1800-080202	plug	8-fold	OD4 (4/2)											17
VT1800-0804	complete	8-fold	OD6 (6/4)	59	13,5	45,5	M36x1	42	36	44	36	40	4	169
VT1800-080401	socket	8-fold	OD6 (6/4)											18
VT1800-080402	plug	8-fold	OD6 (6/4)											18
VT1800-0806	complete	8-fold	OD8 (8/6)	59,5	13,5	46	M50x1	55	48	55	50	55	6	292
VT1800-080601	socket	8-fold	OD8 (8/6)											19
VT1800-080602	plug	8-fold	OD8 (8/6)											19
VT1800-1002	complete	10-fold	OD4 (4/2)	59	13,5	45,5	M36x1	42	36	44	36	40	2	179
VT1800-100201	socket	10-fold	OD4 (4/2)											20
VT1800-100202	plug	10-fold	OD4 (4/2)											20
VT1800-1004	complete	10-fold	OD6 (6/4)	59	13,5	45,5	M50x1	55	48	55	50	55	4	295
VT1800-100401	socket	10-fold	OD6 (6/4)											21
VT1800-100402	plug	10-fold	OD6 (6/4)											21
VT1800-1006	complete	10-fold	OD8 (8/6)	59,5	13,5	46	M60x1	65	58	68	60	65	6	427
VT1800-100601	socket	10-fold	OD8 (8/6)											22
VT1800-100602	plug	10-fold	OD8 (8/6)											22
VT1800-1202	complete	12-fold	OD4 (4/2)	59	13,5	45,5	M36x1	42	36	44	36	40	2	180
VT1800-120201	socket	12-fold	OD4 (4/2)											23
VT1800-120202	plug	12-fold	OD4 (4/2)											23
VT1800-1204	complete	12-fold	OD6 (6/4)	59	13,5	45,5	M50x1	55	48	55	50	55	4	294
VT1800-120401	socket	12-fold	OD6 (6/4)											24
VT1800-120402	plug	12-fold	OD6 (6/4)											24
VT1800-1206	complete	12-fold	OD8 (8/6)	59,5	13,5	46	M60x1	65	58	68	60	65	6	426
VT1800-120601	socket	12-fold	OD8 (8/6)											25
VT1800-120602	plug	12-fold	OD8 (8/6)											25

Series 1811 - Multiple couplings with shut-off

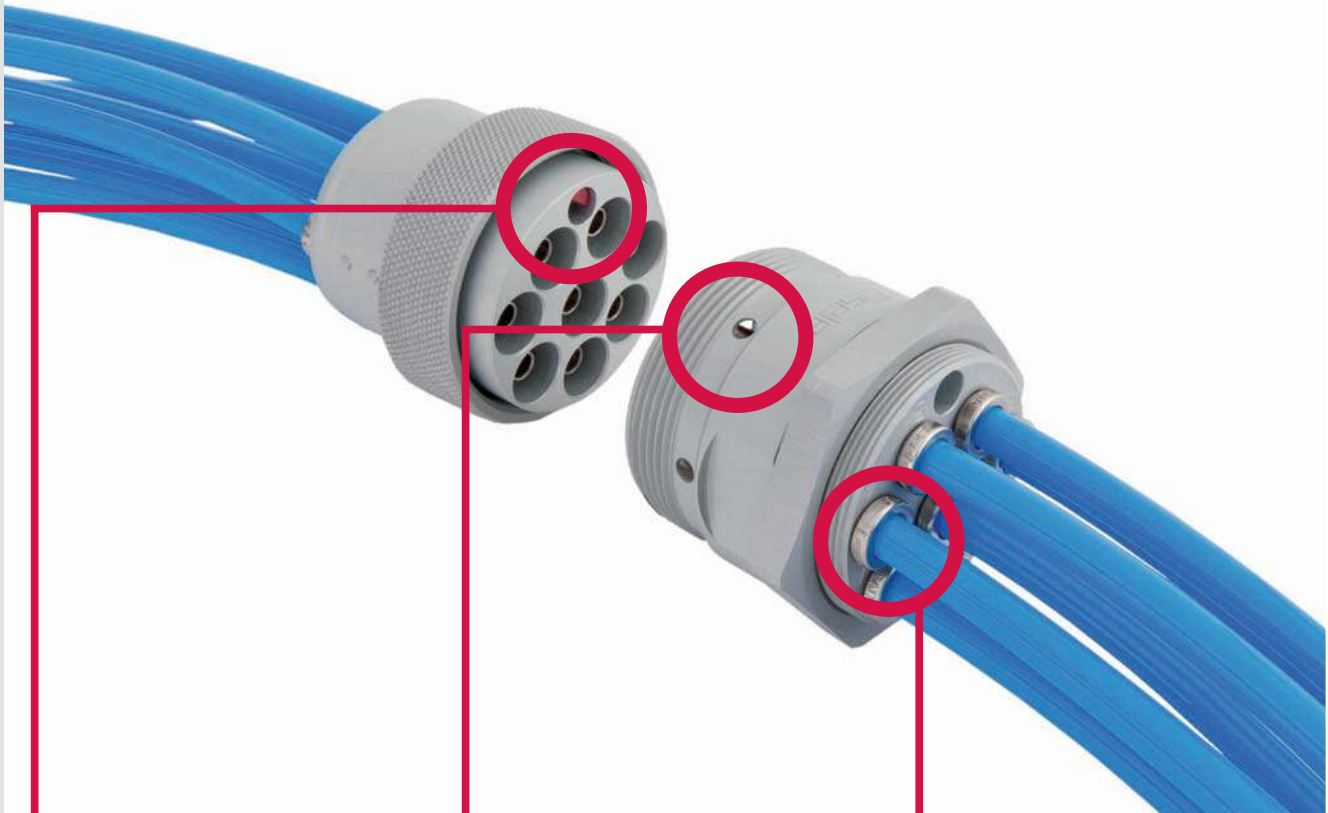

1811

Intuitive Handling

- Plug position can be found through asymmetry
- Considerably better handling
- With bore for coding pins
- 4 coding possibilities available

Time- and Space-saving

- Optimized for constructed spaces
- Patented quick connection

High-quality Processing

- Metal housing
- Made in Germany
- Exclusive design
- With shut-off valves

Suitable accessories like protecting caps, hose bundles and coding pins starting on page

Functional principle

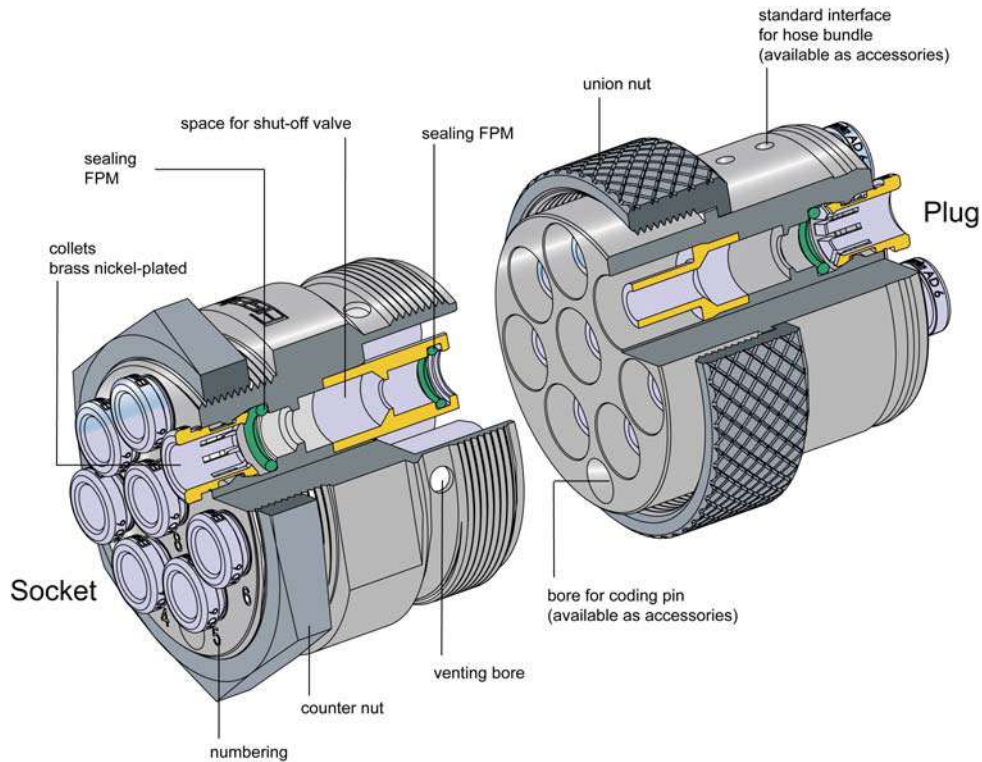

The hoses are inserted into the numbered quick-connect couplings. The hoses are held securely in the housing by the collets. Even after a long period of time, the hoses can be released and re-inserted easily without damage.

When connecting the coupling, the correct position can be found intuitively. Any confusion is impossible, thanks to the optionally-available coding pin. The two halves of the coupling are connected securely using the union nut.

Range of application

- Apparatus engineering
- Mechanical engineering
- Plant engineering

Service conditions

- Temperature range -20 to +120°C
- Working pressure range -0.8 to 0 bar or 0-16 bar
- Flow-rate optimized
- Very fast and easy assembly
- Disassembly without tools possible
- Vacuum version available
- Qualified for compressed air

Handling

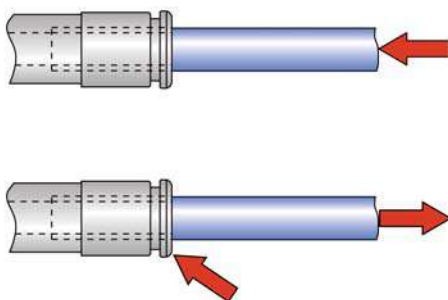

Assembly: Push hose into the connector up to the limit stop

Disassembly: Push release sleeve, pull out hose

Multiple coupling without shut-off

- Plug connectors series 15
- Can be assembled as bulkhead
- Sealing FPM
- Material Al natural anodized, brass nickel-plated
- Temperature range -20 to +120 °C
- Working pressure range -0,8 to 16 bar

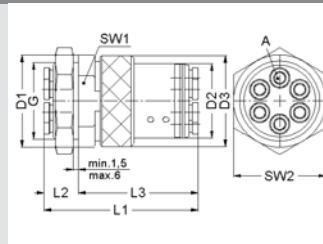

Part no.	Assembly	Design	for hose	L1	L2	L3	G	D1	D2	D3	SW1	SW2	NW	g/piece
VT1811-040200	complete	4-fold	OD4 (4/2)	58,5	13,5	45	M25x1	30	26	34	25	30	2,5	104
VT1811-04020001	socket	4-fold	OD4 (4/2)											11
VT1811-04020002	plug	4-fold	OD4 (4/2)											11
VT1811-040400	complete	4-fold	OD6 (6/4)	72	15,5	56,5	M30x1	35,8	30	39,5	30	36	4	171
VT1811-04040001	socket	4-fold	OD6 (6/4)											12
VT1811-04040002	plug	4-fold	OD6 (6/4)											12
VT1811-040600	complete	4-fold	OD8 (8/6)	87,5	19	68,5	M42x1	48	42	54	42	50	6	421
VT1811-04060001	socket	4-fold	OD8 (8/6)											13
VT1811-04060002	plug	4-fold	OD8 (8/6)											13
VT1811-060200	complete	6-fold	OD4 (4/2)	58,5	13,5	45	M30x1	36	30	39,5	32	36	2,5	150
VT1811-06020001	socket	6-fold	OD4 (4/2)											14
VT1811-06020002	plug	6-fold	OD4 (4/2)											14
VT1811-060400	complete	6-fold	OD6 (6/4)	72,5	16	56,5	M36x1	41,8	36	45	36	41	4	243
VT1811-06040001	socket	6-fold	OD6 (6/4)											15
VT1811-06040002	plug	6-fold	OD6 (6/4)											15
VT1811-060600	complete	6-fold	OD8 (8/6)	87,5	19	68,5	M50x1	56	50	60	50	56	6	540
VT1811-06060001	socket	6-fold	OD8 (8/6)											16
VT1811-06060002	plug	6-fold	OD8 (8/6)											16
VT1811-080200	complete	8-fold	OD4 (4/2)	58,5	13,5	45	M34x1	39,8	34	41,5	34	41	2,5	181
VT1811-08020001	socket	8-fold	OD4 (4/2)											17
VT1811-08020002	plug	8-fold	OD4 (4/2)											17
VT1811-080400	complete	8-fold	OD6 (6/4)	73	16	57	M40x1	45,8	40	49	41	46	4	290
VT1811-08040001	socket	8-fold	OD6 (6/4)											18
VT1811-08040002	plug	8-fold	OD6 (6/4)											18
VT1811-080600	complete	8-fold	OD8 (8/6)	87,5	19	68,5	M54x1	60	55	65	55	60	6	645
VT1811-08060001	socket	8-fold	OD8 (8/6)											19
VT1811-08060002	plug	8-fold	OD8 (8/6)											19
VT1811-100200	complete	10-fold	OD4 (4/2)	58,5	13,5	45	M38x1	50	37	46	41	46	2,5	226
VT1811-10020001	socket	10-fold	OD4 (4/2)											20
VT1811-10020002	plug	10-fold	OD4 (4/2)											20
VT1811-100400	complete	10-fold	OD6 (6/4)	63,5	16	57,5	M46x1	58,8	46	56	46	55	4	384
VT1811-10040001	socket	10-fold	OD6 (6/4)											21
VT1811-10040002	plug	10-fold	OD6 (6/4)											21
VT1811-120200	complete	12-fold	OD4 (4/2)	59,5	13,5	46	M42x1	47,8	42	51,8	46	50	2,5	280
VT1811-12020001	socket	12-fold	OD4 (4/2)											22
VT1811-12020002	plug	12-fold	OD4 (4/2)											22
VT1811-120400	complete	12-fold	OD6 (6/4)	76	16	60	M48x1	54	48	60	50	55	4	443
VT1811-12040001	socket	12-fold	OD6 (6/4)											23
VT1811-12040002	plug	12-fold	OD6 (6/4)											23

1811

Multiple coupling with shut-off on the plug side

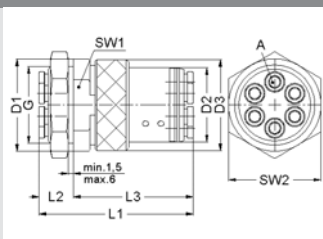

- Plug connectors series 15
- Can be assembled as bulkhead
- Sealing FPM
- Material Al natural anodized, brass nickel-plated
- Temperature range -20 to +120 °C
- Working pressure range 0 to 16 bar

1811

Part no.	Assembly	Design	for hose	L1	L2	L3	G	D1	D2	D3	SW1	SW2	NW	g/piece
VT1811-040201	complete	4-fold	OD4 (4/2)	58,5	13,5	45	M25x1	30	26	34	25	30	2,5	104
VT1811-04020102	plug	4-fold	OD4 (4/2)											11
VT1811-04020001	socket	4-fold	OD4 (4/2)											11
VT1811-040401	complete	4-fold	OD6 (6/4)	72	15,5	56,5	M30x1	35,8	30	39,5	30	36	4	171
VT1811-04040102	plug	4-fold	OD6 (6/4)											12
VT1811-04040001	socket	4-fold	OD6 (6/4)											12
VT1811-040601	complete	4-fold	OD8 (8/6)	87,5	19	68,5	M42x1	48	42	54	42	50	6	421
VT1811-04060102	plug	4-fold	OD8 (8/6)											13
VT1811-04060001	socket	4-fold	OD8 (8/6)											13
VT1811-060201	complete	6-fold	OD4 (4/2)	58,5	13,5	45	M30x1	36	30	39,5	32	36	2,5	150
VT1811-06020102	plug	6-fold	OD4 (4/2)											14
VT1811-06020001	socket	6-fold	OD4 (4/2)											14
VT1811-060401	complete	6-fold	OD6 (6/4)	72,5	16	56,5	M36x1	41,8	36	45	36	41	4	243
VT1811-06040102	plug	6-fold	OD6 (6/4)											15
VT1811-06040001	socket	6-fold	OD6 (6/4)											15
VT1811-060601	complete	6-fold	OD8 (8/6)	87,5	19	68,5	M50x1	56	50	60	50	56	6	540
VT1811-06060102	plug	6-fold	OD8 (8/6)											16
VT1811-06060001	socket	6-fold	OD8 (8/6)											16
VT1811-080201	complete	8-fold	OD4 (4/2)	58,5	13,5	45	M34x1	39,8	34	41,5	34	41	2,5	181
VT1811-08020102	plug	8-fold	OD4 (4/2)											17
VT1811-08020001	socket	8-fold	OD4 (4/2)											17
VT1811-080401	complete	8-fold	OD6 (6/4)	73	16	57	M40x1	45,8	40	49	41	46	4	290
VT1811-08040102	plug	8-fold	OD6 (6/4)											18
VT1811-08040001	socket	8-fold	OD6 (6/4)											18
VT1811-080601	complete	8-fold	OD8 (8/6)	87,5	19	68,5	M54x1	60	55	65	55	60	6	645
VT1811-08060102	plug	8-fold	OD8 (8/6)											19
VT1811-08060001	socket	8-fold	OD8 (8/6)											19
VT1811-100201	complete	10-fold	OD4 (4/2)	58,5	13,5	45	M38x1	50	37	46	41	46	2,5	226
VT1811-10020102	plug	10-fold	OD4 (4/2)											20
VT1811-10020001	socket	10-fold	OD4 (4/2)											20
VT1811-100401	complete	10-fold	OD6 (6/4)	63,5	16	57,5	M46x1	58,8	46	56	46	55	4	384
VT1811-10040102	plug	10-fold	OD6 (6/4)											21
VT1811-10040001	socket	10-fold	OD6 (6/4)											21
VT1811-120201	complete	12-fold	OD4 (4/2)	59,5	13,5	46	M42x1	47,8	42	51,8	46	50	2,5	280
VT1811-12020102	plug	12-fold	OD4 (4/2)											22
VT1811-12020001	socket	12-fold	OD4 (4/2)											22
VT1811-120401	complete	12-fold	OD6 (6/4)	76	16	60	M48x1	54	48	60	48	55	4	443
VT1811-12040102	plug	12-fold	OD6 (6/4)											23
VT1811-12040001	socket	12-fold	OD6 (6/4)											23

Multiple coupling with shut-off on the socket side

- Plug connectors series 15
- Can be assembled as bulkhead
- Sealing FPM
- Material Al natural anodized, brass nickel-plated
- Temperature range -20 to +120 °C
- Working pressure range 0 to 16 bar

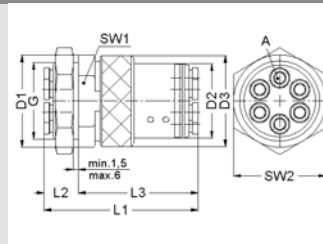

Part no.	Assembly	Design	for hose	L1	L2	L3	G	D1	D2	D3	SW1	SW2	NW	g/piece
VT1811-040210	complete	4-fold	OD4 (4/2)	58,5	13,5	45	M25x1	30	26	34	25	30	2,5	104
VT1811-04021001	socket	4-fold	OD4 (4/2)											11
VT1811-04020002	plug	4-fold	OD4 (4/2)											11
VT1811-040410	complete	4-fold	OD6 (6/4)	72	15,5	56,5	M30x1	35,8	30	39,5	30	36	4	171
VT1811-04041001	socket	4-fold	OD6 (6/4)											12
VT1811-04040002	plug	4-fold	OD6 (6/4)											12
VT1811-040610	complete	4-fold	OD8 (8/6)	87,5	19	68,5	M42x1	48	42	54	42	50	6	421
VT1811-04061001	socket	4-fold	OD8 (8/6)											13
VT1811-04060002	plug	4-fold	OD8 (8/6)											13
VT1811-060210	complete	6-fold	OD4 (4/2)	58,5	13,5	45	M30x1	36	30	39,5	32	36	2,5	150
VT1811-06021001	socket	6-fold	OD4 (4/2)											14
VT1811-06020002	plug	6-fold	OD4 (4/2)											14
VT1811-060410	complete	6-fold	OD6 (6/4)	72,5	16	56,5	M36x1	41,8	36	45	36	41	4	243
VT1811-06041001	socket	6-fold	OD6 (6/4)											15
VT1811-06040002	plug	6-fold	OD6 (6/4)											15
VT1811-060610	complete	6-fold	OD8 (8/6)	87,5	19	68,5	M50x1	56	50	60	50	56	6	540
VT1811-06061001	socket	6-fold	OD8 (8/6)											16
VT1811-06060002	plug	6-fold	OD8 (8/6)											16
VT1811-080210	complete	8-fold	OD4 (4/2)	58,5	13,5	45	M34x1	39,8	34	41,5	34	41	2,5	181
VT1811-08021001	socket	8-fold	OD4 (4/2)											17
VT1811-08020002	plug	8-fold	OD4 (4/2)											17
VT1811-080410	complete	8-fold	OD6 (6/4)	73	16	57	M40x1	45,8	40	49	41	46	4	290
VT1811-08041001	socket	8-fold	OD6 (6/4)											18
VT1811-08040002	plug	8-fold	OD6 (6/4)											18
VT1811-080610	complete	8-fold	OD8 (8/6)	87,5	19	68,5	M54x1	60	55	65	55	60	6	645
VT1811-08061001	socket	8-fold	OD8 (8/6)											19
VT1811-08060002	plug	8-fold	OD8 (8/6)											19
VT1811-100210	complete	10-fold	OD4 (4/2)	58,5	13,5	45	M38x1	50	37	46	41	46	2,5	226
VT1811-10021001	socket	10-fold	OD4 (4/2)											20
VT1811-10020002	plug	10-fold	OD4 (4/2)											20
VT1811-100410	complete	10-fold	OD6 (6/4)	63,5	16	57,5	M46x1	58,8	46	56	46	55	4	384
VT1811-10041001	socket	10-fold	OD6 (6/4)											21
VT1811-10040002	plug	10-fold	OD6 (6/4)											21
VT1811-120210	complete	12-fold	OD4 (4/2)	59,5	13,5	46	M42x1	47,8	42	51,8	46	50	2,5	280
VT1811-12021001	socket	12-fold	OD4 (4/2)											22
VT1811-12020002	plug	12-fold	OD4 (4/2)											22
VT1811-120410	complete	12-fold	OD6 (6/4)	76	16	60	M48x1	54	48	60	48	55	4	443
VT1811-12041001	socket	12-fold	OD6 (6/4)											23
VT1811-12040002	plug	12-fold	OD6 (6/4)											23

1811

Multiple coupling with shut-off on both sides

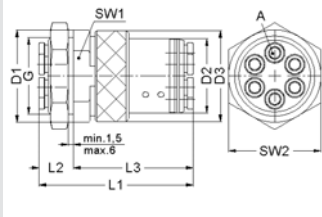

- Plug connectors series 15
- Can be assembled as bulkhead
- Sealing FPM
- Material Al natural anodized, brass nickel-plated
- Temperature range -20 to +120 °C
- Working pressure range 0 to 16 bar

1811

Part no.	Assembly	Design	for hose	L1	L2	L3	G	D1	D2	D3	SW1	SW2	NW	g/piece
VT1811-040211	complete	4-fold	OD4 (4/2)	58,5	13,5	45	M25x1	30	26	34	25	30	2,5	104
VT1811-04020102	plug	4-fold	OD4 (4/2)											11
VT1811-04021001	socket	4-fold	OD4 (4/2)											11
VT1811-040411	complete	4-fold	OD6 (6/4)	72	15,5	56,5	M30x1	35,8	30	39,5	30	36	4	171
VT1811-04040102	plug	4-fold	OD6 (6/4)											12
VT1811-04041001	socket	4-fold	OD6 (6/4)											12
VT1811-040611	complete	4-fold	OD8 (8/6)	87,5	19	68,5	M42x1	48	42	54	42	50	6	421
VT1811-04060102	plug	4-fold	OD8 (8/6)											13
VT1811-04061001	socket	4-fold	OD8 (8/6)											13
VT1811-060211	complete	6-fold	OD4 (4/2)	58,5	13,5	45	M30x1	36	30	39,5	32	36	2,5	150
VT1811-06020102	plug	6-fold	OD4 (4/2)											14
VT1811-06021001	socket	6-fold	OD4 (4/2)											14
VT1811-060411	complete	6-fold	OD6 (6/4)	72,5	16	56,5	M36x1	41,8	36	45	36	41	4	243
VT1811-06040102	plug	6-fold	OD6 (6/4)											15
VT1811-06041001	socket	6-fold	OD6 (6/4)											15
VT1811-060611	complete	6-fold	OD8 (8/6)	87,5	19	68,5	M50x1	56	50	60	50	56	6	540
VT1811-06060102	plug	6-fold	OD8 (8/6)											16
VT1811-06061001	socket	6-fold	OD8 (8/6)											16
VT1811-080211	complete	8-fold	OD4 (4/2)	58,5	13,5	45	M34x1	39,8	34	41,5	34	41	2,5	181
VT1811-08020102	plug	8-fold	OD4 (4/2)											17
VT1811-08021001	socket	8-fold	OD4 (4/2)											17
VT1811-080411	complete	8-fold	OD6 (6/4)	73	16	57	M40x1	45,8	40	49	41	46	4	290
VT1811-08040102	plug	8-fold	OD6 (6/4)											18
VT1811-08041001	socket	8-fold	OD6 (6/4)											18
VT1811-080611	complete	8-fold	OD8 (8/6)	87,5	19	68,5	M54x1	60	55	65	55	60	6	645
VT1811-08060102	plug	8-fold	OD8 (8/6)											19
VT1811-08061001	socket	8-fold	OD8 (8/6)											19
VT1811-100211	complete	10-fold	OD4 (4/2)	58,5	13,5	45	M38x1	50	37	46	41	46	2,5	226
VT1811-10020102	plug	10-fold	OD4 (4/2)											20
VT1811-10021001	socket	10-fold	OD4 (4/2)											20
VT1811-100411	complete	10-fold	OD6 (6/4)	63,5	16	57,5	M46x1	58,8	46	56	46	55	4	384
VT1811-10040102	plug	10-fold	OD6 (6/4)											21
VT1811-10041001	socket	10-fold	OD6 (6/4)											21
VT1811-120211	complete	12-fold	OD4 (4/2)	59,5	13,5	46	M42x1	47,8	42	51,8	46	50	2,5	280
VT1811-12020102	plug	12-fold	OD4 (4/2)											22
VT1811-12021001	socket	12-fold	OD4 (4/2)											22
VT1811-120411	complete	12-fold	OD6 (6/4)	76	16	60	M48x1	54	48	60	48	55	4	443
VT1811-12040102	plug	12-fold	OD6 (6/4)											23
VT1811-12041001	socket	12-fold	OD6 (6/4)											23

Multiple coupling with shut-off on the plug side - vacuum version

- Plug connectors Series 15
- Can be assembled as bulkhead
- Sealing FPM
- Material Al natural anodized, brass nickel-plated
- Temperature range -20 to +120 °C
- Working pressure range -0.8 to 0 bar

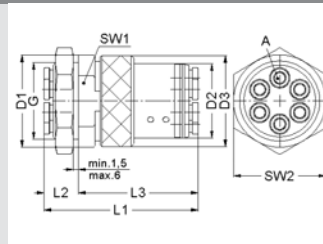

Part no.	Assembly	Design	for hose	L1	L2	L3	G	D1	D2	D3	SW1	SW2	NW	g/piece
VT1811-040202	complete	4-fold	OD4 (4/2)	58,5	13,5	45	M25x1	30	26	34	25	30	2,5	104
VT1811-04020202	plug	4-fold	OD4 (4/2)											11
VT1811-04020001	socket	4-fold	OD4 (4/2)											11
VT1811-040402	complete	4-fold	OD6 (6/4)	72	15,5	56,5	M30x1	35,8	30	39,5	30	36	4	171
VT1811-04040202	plug	4-fold	OD6 (6/4)											12
VT1811-04040001	socket	4-fold	OD6 (6/4)											12
VT1811-040602	complete	4-fold	OD8 (8/6)	87,5	19	68,5	M42x1	48	42	54	42	50	6	421
VT1811-04060202	plug	4-fold	OD8 (8/6)											13
VT1811-04060001	socket	4-fold	OD8 (8/6)											13
VT1811-060202	complete	6-fold	OD4 (4/2)	58,5	13,5	45	M30x1	36	30	39,5	32	36	2,5	150
VT1811-06020202	plug	6-fold	OD4 (4/2)											14
VT1811-06020001	socket	6-fold	OD4 (4/2)											14
VT1811-060402	complete	6-fold	OD6 (6/4)	72,5	16	56,5	M36x1	41,8	36	45	36	41	4	243
VT1811-06040202	plug	6-fold	OD6 (6/4)											15
VT1811-06040001	socket	6-fold	OD6 (6/4)											15
VT1811-060602	complete	6-fold	OD8 (8/6)	87,5	19	68,5	M50x1	56	50	60	50	56	6	540
VT1811-06060202	plug	6-fold	OD8 (8/6)											16
VT1811-06060001	socket	6-fold	OD8 (8/6)											16
VT1811-080202	complete	8-fold	OD4 (4/2)	58,5	13,5	45	M34x1	39,8	34	41,5	34	41	2,5	181
VT1811-08020202	plug	8-fold	OD4 (4/2)											17
VT1811-08020001	socket	8-fold	OD4 (4/2)											17
VT1811-080402	complete	8-fold	OD6 (6/4)	73	16	57	M40x1	45,8	40	49	41	46	4	290
VT1811-08040202	plug	8-fold	OD6 (6/4)											18
VT1811-08040001	socket	8-fold	OD6 (6/4)											18
VT1811-080602	complete	8-fold	OD8 (8/6)	87,5	19	68,5	M54x1	60	55	65	55	60	6	645
VT1811-08060202	plug	8-fold	OD8 (8/6)											19
VT1811-08060001	socket	8-fold	OD8 (8/6)											19
VT1811-100202	complete	10-fold	OD4 (4/2)	58,5	13,5	45	M38x1	50	37	46	41	46	2,5	226
VT1811-10020202	plug	10-fold	OD4 (4/2)											20
VT1811-10020001	socket	10-fold	OD4 (4/2)											20
VT1811-100402	complete	10-fold	OD6 (6/4)	63,5	16	57,5	M46x1	58,8	46	56	46	55	4	384
VT1811-10040202	plug	10-fold	OD6 (6/4)											21
VT1811-10040001	socket	10-fold	OD6 (6/4)											21
VT1811-120202	complete	12-fold	OD4 (4/2)	59,5	13,5	46	M42x1	47,8	42	51,8	46	50	2,5	280
VT1811-12020202	plug	12-fold	OD4 (4/2)											22
VT1811-12020001	socket	12-fold	OD4 (4/2)											22
VT1811-120402	complete	12-fold	OD6 (6/4)	76	16	60	M48x1	54	48	60	48	55	4	443
VT1811-12040202	plug	12-fold	OD6 (6/4)											23
VT1811-12040001	socket	12-fold	OD6 (6/4)											23

1811

Multiple coupling with shut-off on the socket side - vacuum version

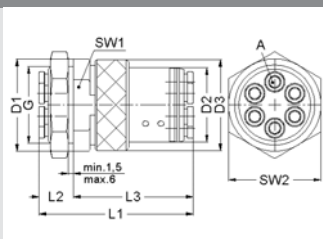

- Plug connectors Series 15
- Can be assembled as bulkhead
- Sealing FPM
- Material Al natural anodized, brass nickel-plated
- Temperature range -20 to +120 °C
- Working pressure range -0.8 to 0 bar

1811

Part no.	Assembly	Design	for hose	L1	L2	L3	G	D1	D2	D3	SW1	SW2	NW	g/piece
VT1811-040220	complete	4-fold	OD4 (4/2)	58,5	13,5	45	M25x1	30	26	34	25	30	2,5	104
VT1811-04022001	socket	4-fold	OD4 (4/2)											11
VT1811-04020002	plug	4-fold	OD4 (4/2)											11
VT1811-040420	complete	4-fold	OD6 (6/4)	72	15,5	56,5	M30x1	35,8	30	39,5	30	36	4	171
VT1811-04042001	socket	4-fold	OD6 (6/4)											12
VT1811-04040002	plug	4-fold	OD6 (6/4)											12
VT1811-040620	complete	4-fold	OD8 (8/6)	87,5	19	68,5	M42x1	48	42	54	42	50	6	421
VT1811-04062001	socket	4-fold	OD8 (8/6)											13
VT1811-04060002	plug	4-fold	OD8 (8/6)											13
VT1811-060220	complete	6-fold	OD4 (4/2)	58,5	13,5	45	M30x1	36	30	39,5	32	36	2,5	150
VT1811-06022001	socket	6-fold	OD4 (4/2)											14
VT1811-06020002	plug	6-fold	OD4 (4/2)											14
VT1811-060420	complete	6-fold	OD6 (6/4)	72,5	16	56,5	M36x1	41,8	36	45	36	41	4	243
VT1811-06042001	socket	6-fold	OD6 (6/4)											15
VT1811-06040002	plug	6-fold	OD6 (6/4)											15
VT1811-060620	complete	6-fold	OD8 (8/6)	87,5	19	68,5	M50x1	56	50	60	50	56	6	540
VT1811-06062001	socket	6-fold	OD8 (8/6)											16
VT1811-06060002	plug	6-fold	OD8 (8/6)											16
VT1811-080220	complete	8-fold	OD4 (4/2)	58,5	13,5	45	M34x1	39,8	34	41,5	34	41	2,5	181
VT1811-08022001	socket	8-fold	OD4 (4/2)											17
VT1811-08020002	plug	8-fold	OD4 (4/2)											17
VT1811-080420	complete	8-fold	OD6 (6/4)	73	16	57	M40x1	45,8	40	49	41	46	4	290
VT1811-08042001	socket	8-fold	OD6 (6/4)											18
VT1811-08040002	plug	8-fold	OD6 (6/4)											18
VT1811-080620	complete	8-fold	OD8 (8/6)	87,5	19	68,5	M54x1	60	55	65	55	60	6	645
VT1811-08062001	socket	8-fold	OD8 (8/6)											19
VT1811-08060002	plug	8-fold	OD8 (8/6)											19
VT1811-100220	complete	10-fold	OD4 (4/2)	58,5	13,5	45	M38x1	50	37	46	41	46	2,5	226
VT1811-10022001	socket	10-fold	OD4 (4/2)											20
VT1811-10020002	plug	10-fold	OD4 (4/2)											20
VT1811-100420	complete	10-fold	OD6 (6/4)	63,5	16	57,5	M46x1	58,8	46	56	46	55	4	384
VT1811-10042001	socket	10-fold	OD6 (6/4)											21
VT1811-10040002	plug	10-fold	OD6 (6/4)											21
VT1811-120220	complete	12-fold	OD4 (4/2)	59,5	13,5	46	M42x1	47,8	42	51,8	46	50	2,5	280
VT1811-12022001	socket	12-fold	OD4 (4/2)											22
VT1811-12020002	plug	12-fold	OD4 (4/2)											22
VT1811-120420	complete	12-fold	OD6 (6/4)	76	16	60	M48x1	54	48	60	48	55	4	443
VT1811-12042001	socket	12-fold	OD6 (6/4)											23
VT1811-12040002	plug	12-fold	OD6 (6/4)											23

Multiple coupling with shut-off on both sides - vacuum version

- Plug connectors Series 15
- Can be assembled as bulkhead
- Sealing FPM
- Material Al natural anodized, brass nickel-plated
- Temperature range -20 to +120 °C
- Working pressure range -0.8 to 0 bar

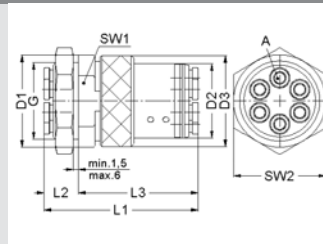

Part no.	Assembly	Design	for hose	L1	L2	L3	G	D1	D2	D3	SW1	SW2	NW	g/piece
VT1811-040222	complete	4-fold	OD4 (4/2)	58,5	13,5	45	M25x1	30	26	34	25	30	2,5	104
VT1811-04022001	socket	4-fold	OD4 (4/2)											11
VT1811-04020202	plug	4-fold	OD4 (4/2)											11
VT1811-040422	complete	4-fold	OD6 (6/4)	72	15,5	56,5	M30x1	35,8	30	39,5	30	36	4	171
VT1811-04042001	socket	4-fold	OD6 (6/4)											12
VT1811-04040202	plug	4-fold	OD6 (6/4)											12
VT1811-040622	complete	4-fold	OD8 (8/6)	87,5	19	68,5	M42x1	48	42	54	42	50	6	421
VT1811-04062001	socket	4-fold	OD8 (8/6)											13
VT1811-04060202	plug	4-fold	OD8 (8/6)											13
VT1811-060222	complete	6-fold	OD4 (4/2)	58,5	13,5	45	M30x1	36	30	39,5	32	36	2,5	150
VT1811-06022001	socket	6-fold	OD4 (4/2)											14
VT1811-06020202	plug	6-fold	OD4 (4/2)											14
VT1811-060422	complete	6-fold	OD6 (6/4)	72,5	16	56,5	M36x1	41,8	36	45	36	41	4	243
VT1811-06042001	socket	6-fold	OD6 (6/4)											15
VT1811-06040202	plug	6-fold	OD6 (6/4)											15
VT1811-060622	complete	6-fold	OD8 (8/6)	87,5	19	68,5	M50x1	56	50	60	50	56	6	540
VT1811-06062001	socket	6-fold	OD8 (8/6)											16
VT1811-06060202	plug	6-fold	OD8 (8/6)											16
VT1811-080222	complete	8-fold	OD4 (4/2)	58,5	13,5	45	M34x1	39,8	34	41,5	34	41	2,5	181
VT1811-08022001	socket	8-fold	OD4 (4/2)											17
VT1811-08020202	plug	8-fold	OD4 (4/2)											17
VT1811-080422	complete	8-fold	OD6 (6/4)	73	16	57	M40x1	45,8	40	49	41	46	4	290
VT1811-08042001	socket	8-fold	OD6 (6/4)											18
VT1811-08040202	plug	8-fold	OD6 (6/4)											18
VT1811-080622	complete	8-fold	OD8 (8/6)	87,5	19	68,5	M54x1	60	55	65	55	60	6	645
VT1811-08062001	socket	8-fold	OD8 (8/6)											19
VT1811-08060202	plug	8-fold	OD8 (8/6)											19
VT1811-100222	complete	10-fold	OD4 (4/2)	58,5	13,5	45	M38x1	50	37	46	41	46	2,5	226
VT1811-10022001	socket	10-fold	OD4 (4/2)											20
VT1811-10020202	plug	10-fold	OD4 (4/2)											20
VT1811-100422	complete	10-fold	OD6 (6/4)	63,5	16	57,5	M46x1	58,8	46	56	46	55	4	384
VT1811-10042001	socket	10-fold	OD6 (6/4)											21
VT1811-10040202	plug	10-fold	OD6 (6/4)											21
VT1811-120222	complete	12-fold	OD4 (4/2)	59,5	13,5	46	M42x1	47,8	42	51,8	46	50	2,5	280
VT1811-12022001	socket	12-fold	OD4 (4/2)											22
VT1811-12020202	plug	12-fold	OD4 (4/2)											22
VT1811-120422	complete	12-fold	OD6 (6/4)	76	16	60	M48x1	54	48	60	48	55	4	443
VT1811-12042001	socket	12-fold	OD6 (6/4)											23
VT1811-12040202	plug	12-fold	OD6 (6/4)											23

1811

Series 1870 + 1871 - Electro-pneumatical multiple couplings

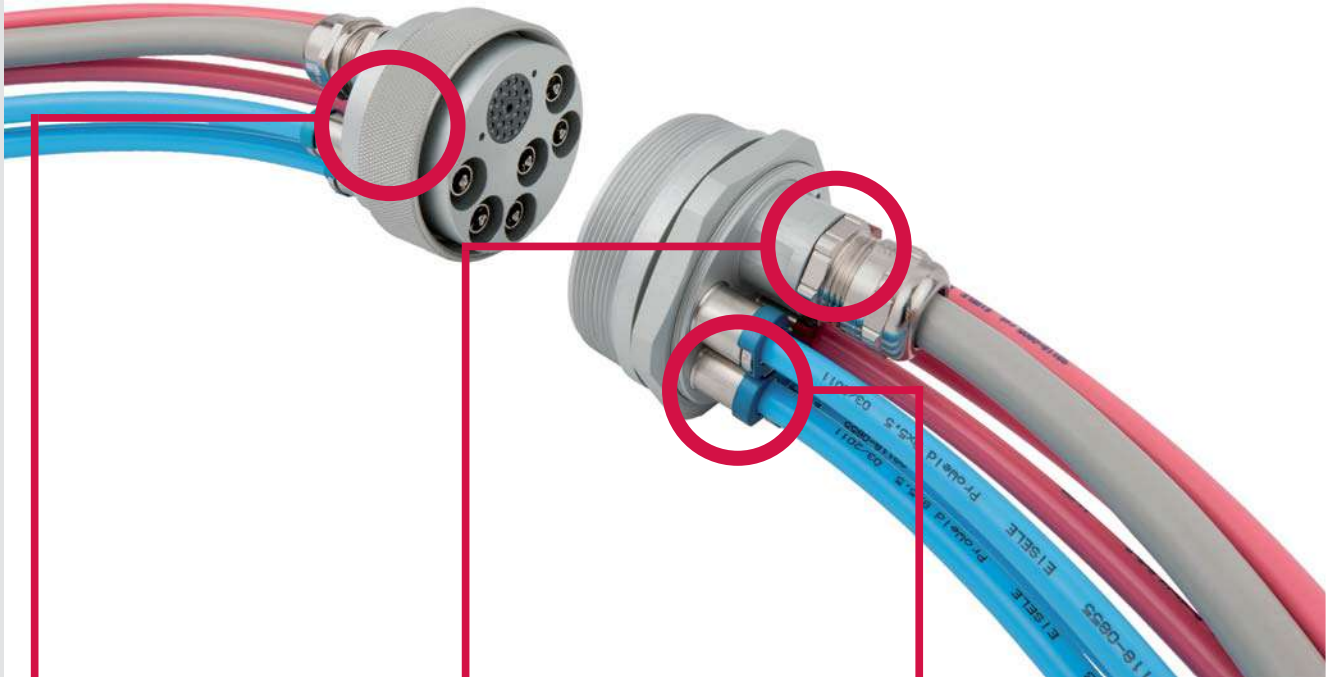

Body

- full metal body
- exclusive design
- bulkhead connector
- IP68 planned
- space optimised design

Electric

- approved electric connector
- contact durability
- suitable for high electrical current
- 3 to 26 contacts possible

Pneumatic

- with shut-off valves
- compressed air 0 to 16 bar or -0,8 to 0 bar
- Hose outer diameter 4, 6 and 8 mm on one coupling possible
- reducing is possible (e.g. OD8 to OD4)
- flow-rate optimized
- color coding of the pneumatic fittings possible
- connectable under pressure

1870+1871

Functional principle

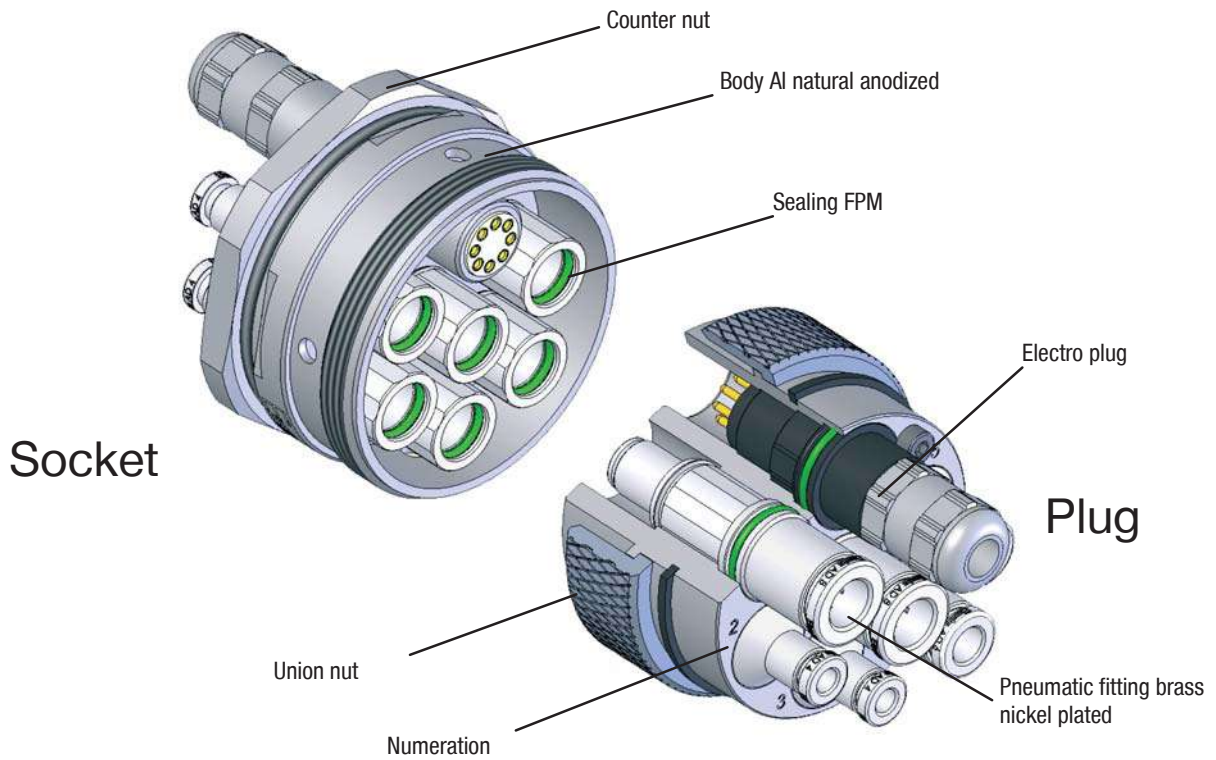

1870+1871

Range of application

- Tool change
- Modularization
- Module change
- Valve terminals
- Cylinder with limit switch
- Machinery
- Mechanical engineering
- Plant engineering

Service conditions

- Temperature range: -20 to +120°C
- Working pressure range -0.8 to 0 bar or 0 to 16 bar
- easy and quick mounting and dismounting
- non conducting body
- electrical grounding upon request
- allowable medium: compressed air
- Fluids upon request
- IP68 planned

Handling

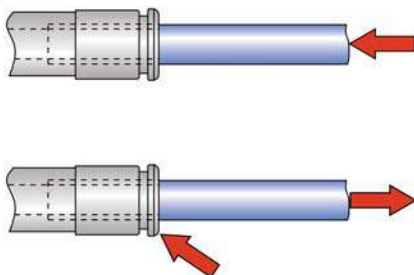

Assembly: Push hose into the connector up to the limit stop

Disassembly: Push release sleeve, pull out hose

Electro plug

- the electro plug is a unit itself and can be easily dismantled
- several electro plugs can be chosen (see below)
- cable harness can be made outside the coupling (by customer or by Eisele)
- high quality electro plugs used for military and medicine applications

Electro plug for series 1870 - 26 poles



Plug



Socket

1870+1871

1870 Electro-plug with solder contact

Number of poles	AWG	A (mm ²)	Nominal voltage (V)	Nominal current (A)
26	20-24	0,2-0,52	24	22

1870 Electro-plug with crimp contact

Number of poles	AWG	A (mm ²)	Nominal voltage (V)	Nominal current (A)
26	20-24	0,2-0,52	24	22

Electro plug for series 1871 - 3 to 10 poles

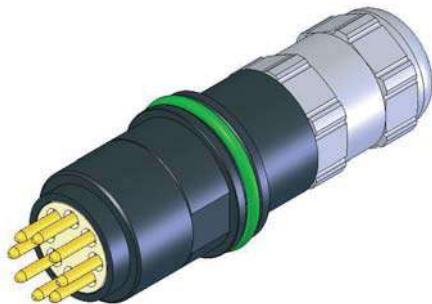

Plug



Socket

1871 Electro-plug with solder contact

Number of poles	contact diameter (mm)	AWG	A (mm ²)	Nominal voltage (V)	Nominal current (A)
3	2	-	2,5	24	22
4	2	-	2,5	24	22
7	1,6	18	1	24	17
8	1,3	20	0,5	24	14
10	1,3	20	0,5	24	14

1871 Electro-plug with crimp contact

Number of poles	contact diameter (mm)	AWG	A (mm ²)	Nominal voltage (V)	Nominal current (A)
7	1,6	16	-	24	17
8	1,3	18	1	24	14
10	1,3	18	1	24	14

Pneumatic fittings

- the pneumatic fittings are a unit itself and can be combined flexible
- fittings for hose outer-diameter OD4, OD6 and OD8 available
- reducing is possible (e.g. plug side with OD8 mm and socket side with OD6 mm hose connection)

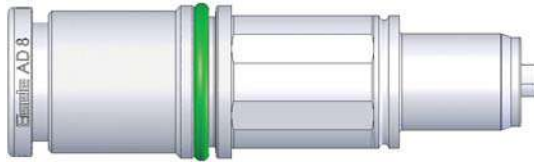

Plug

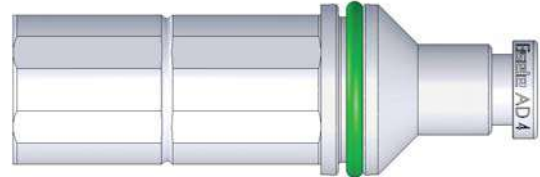

Socket

1870+1871

- other configurations, hose sizes and solutions upon request
- Couplings for fluids upon request

Electropneumatic multiple coupling - Series 1870

- Plug connectors series 15
- Can be assembled as bulkhead
- Sealing FPM
- Material Al natural anodized, brass nickel-plated
- Temperature range -20 to +120 °C
- Working pressure range 0 to 16 bar

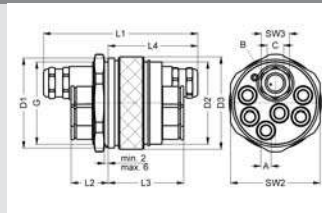

Part no.	Design	for hose A	number of poles B	Sealing range C	L1	L2	L3	L4	G	D1	D2	D3	SW2	SW3	g/piece
VT1870-060626C-001	6-fold	OD8 (8/6)	26	7 - 13	130	29	53	70	M64x1	70	64	72	70	24	849
VT1870-060626C-002	6-fold	OD6 (6/4)	26	7 - 13	130	28	52	70	M64x1	70	64	72	70	24	849
VT1870-060626C-003	6-fold	OD4 (4/2)	26	7 - 13	130	25,5	49,5	70	M64x1	70	64	72	70	24	849

Electropneumatic multiple coupling, vacuum version - Series 1870

- Plug connectors Series 15
- Can be assembled as bulkhead
- Sealing FPM
- Material Al natural anodized, brass nickel-plated
- Temperature range -20 to +120 °C
- Working pressure range -0.8 to 0 bar

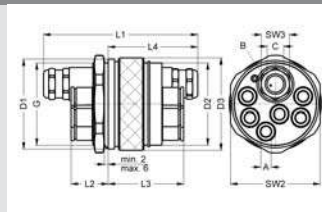

1870+1871

Part no.	Design	for hose A	number of poles B	Sealing range C	L1	L2	L3	L4	G	D1	D2	D3	SW2	SW3	g/piece
VT1870-060626C-004	6-fold	OD8 (8/6)	26	7 - 13	130	29	53	70	M64x1	70	64	72	70	24	849
VT1870-060626C-005	6-fold	OD6 (6/4)	26	7 - 13	130	28	52	70	M64x1	70	64	72	70	24	849
VT1870-060626C-006	6-fold	OD4 (4/2)	26	7 - 13	130	25,5	49,5	70	M64x1	70	64	72	70	24	849

Electropneumatic multiple coupling - Series 1871

- Plug connectors series 15
- Can be assembled as bulkhead
- Sealing FPM
- Material Al natural anodized, brass nickel-plated
- Temperature range -20 to +120 °C
- Working pressure range 0 to 16 bar

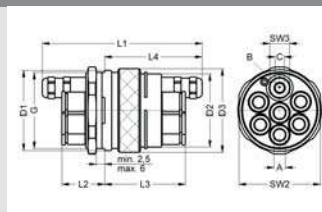

Part no.	Design	for hose A	number of poles B	Sealing range C	L1	L2	L3	L4	G	D1	D2	D3	SW2	SW3	g/piece
VT1871-060610C-001	6-fold	OD8 (8/6)	10	3-7	114	30,5	57,5	69,5	M54x1	57	52	59,5	58	14	649
VT1871-060610C-002	6-fold	OD6 (6/4)	10	3-7	114	29,5	56,5	69,5	M54x1	57	52	59,5	58	14	621
VT1871-060610C-003	6-fold	OD4 (4/2)	10	3-7	114	27	54	69,5	M54x1	57	52	59,5	58	14	592

Electropneumatic multiple coupling, vacuum version - Series 1871

- Plug connectors Series 15
- Can be assembled as bulkhead
- Sealing FPM
- Material Al natural anodized, brass nickel-plated
- Temperature range -20 to +120 °C
- Working pressure range -0.8 to 0 bar

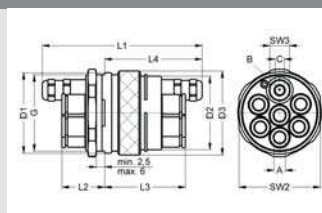

Part no.	Design	for hose A	number of poles B	Sealing range C	L1	L2	L3	L4	G	D1	D2	D3	SW2	SW3	g/piece
VT1871-060610C-004	6-fold	OD8 (8/6)	10	3-7	114	30,5	57,5	69,5	M54x1	57	52	59,5	58	14	649
VT1871-060610C-005	6-fold	OD6 (6/4)	10	3-7	114	29,5	56,5	69,5	M54x1	57	52	59,5	58	14	621
VT1871-060610C-006	6-fold	OD4 (4/2)	10	3-7	114	27	54	69,5	M54x1	57	52	59,5	58	14	592

Accessories



Hose bundle

- protects coupling from dirt
- no deviation of the hose
- strain relief of the hoses

Coding pin

- color and mechanical coding
- simplified mounting
- defective mounting is impossible

Protection cap

- prevents soiling in opened condition

ACC

Hose bundle

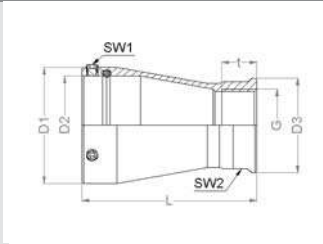

- Optimal handling through hose bundles
- Will be screwed on the coupling
- D2 hose bundles must be equal to D2 coupling
- Material Al natural anodized
- Sealing FPM
- Temperature range -20 to +120°C

Part no.	G	SW1	SW2	L1	D1	D2	D3	t	g/piece
VT1800-990123	M20x1,5	2	24	50	29,5	23	26	11	26
VT1800-990126	M20x1,5	2	24	50	32	26	26	11	25
VT1800-990129	M25x1,5	2	30	52	35	29	32,5	12	34
VT1800-990130	M25x1,5	2	30	52	36	30	32,5	12	34
VT1800-990134	M25x1,5	2	30	60	40	34	32,5	12	45
VT1800-990136	M32x1,5	2	36	67	42	36	40	14	54
VT1800-990137	M32x1,5	2	36	67	43	37	40	14	56
VT1800-990140	M32x1,5	2	36	72	46	40	40	14	63
VT1800-990142	M40x1,5	2	42	80	48	42	48	14	82
VT1800-990146	M40x1,5	2	42	80	52	46	48	14	83
VT1800-990148	M40x1,5	2	42	80	54	48	48	14	83
VT1800-990150	M40x1,5	2	42	80	57	50	48	14	93
VT1800-990155	M40x1,5	2	42	80	62	55	48	14	92
VT1800-990158	M50x1,5	2	55	82	65	58	60	20	134

ACC

Coding pin



- Compatible with all multiple couplings of the 1811 series
- For color and mechanical coding
- 4 coding pins available, more coding pins on request
- Easy assembly by screwing
- Material Al anodized
- Packaging unit: 2 pieces (1x for socket; 1x for plug)

Part no.	article description	Color	Marking	g/piece
1811-9800	installation tool, for easy assembling			4
1811-9810	coding pins (2 pcs)	natural	1	2
1811-9820	coding pins (2 pcs)	black	2	2
1811-9830	coding pins (2 pcs)	blue	3	2
1811-9840	coding pins (2 pcs)	red	4	2
1811-9814	coding pin set 1-4 (2 pcs)	diverse	No. 1-4	2

protection cap

- protection caps compatible with socket and plug of series VT1800 and VT1811
- Material polyethylene (PE)



Part no.	for plug or socket
1800-97243	VT1800-040202
1800-97257	VT1800-040201 VT1811-0402XX02
1800-97300	VT1800-040401 VT1800-040401 VT1800-060201 VT1800-060202 VT1800-080202 VT1811-0402XX01 VT1811-0404XX02 VT1811-0602XX02
1800-97320	VT1800-040402 VT1800-080201
1800-97336	VT1800-040602 VT1800-080402 VT1800-120202 VT1811-0802XX02
1800-97345	VT1800-100202 VT1811-0404XX01 VT1811-0602XX01
1800-97355	VT1800-060402
1800-97379	VT1811-0802XX01
1800-97385	VT1800-040601 VT1800-060401 VT1800-080401 VT1800-100201 VT1800-120201 VT1811-0604XX02 VT1811-1002XX02
1800-97413	VT1811-0804XX02 VT1811-1002XX01
1800-97439	VT1811-0406XX02 VT1811-0604XX01 VT1811-120202
1800-97445	VT1811-0804XX01
1800-97479	VT1800-060602 VT1800-080602 VT1800-100402 VT1800-120402 VT1811-1004XX02
1800-97498	VT1811-0406XX01 VT1811-120201 VT1811-1204XX02
1800-97505	VT1800-060601 VT1800-080601 VT1800-100401 VT1800-120401 VT1811-0606XX02 VT1811-1004XX01
1800-97555	VT1800-120602 VT1811-1204XX01
1800-97570	VT1811-0606XX01 VT1811-0806XX02
1800-97605	VT1800-100602
1800-97613	VT1800-100601 VT1800-120601 VT1811-0806XX01

ACC

EISELE MULTILINE

Reducing plug

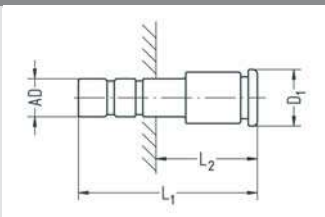

- Sealing NBR
- Material brass nickel-plated
- Temperature range -20 to +80 °C
- Working pressure range -0.95 to 15 bar

Part no.	plug AD	for hose	L1	L2	D1	NW	g/piece
821-0204	4	OD6 (6/4)	35,5	22	11,4	2	9
821-0206	4	OD8 (8/6)	37	23,5	14,6	2	13
821-0402	6	OD4 (4/2)	32,5	15,5	8,6	2	6
821-0406	6	OD8 (8/6)	39	22	14,6	4	14
821-0602	8	OD4 (4/2)	28	9,3	9,8	2	6
821-0604	8	OD6 (6/4)	38	16,3	11,4	4	10
821-0806	10	OD8 (8/6)	43	22	14,6	6	16
821-0906	12	OD8 (8/6)	47,5	21,5	14,6	6	23
821-0908	12	OD10 (10/8)	53,5	27,5	16,6	8	30
821-1108	14	OD10 (10/8)	53	25	16,6	8	31
821-1109	14	OD12 (12/9)	61	33	19,9	9	48

Reducing plug

ACC

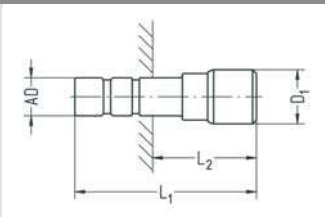

- Sealing NBR
- Material brass nickel-plated
- Temperature range -20 to +80 °C
- Working pressure range -0.95 to 16 bar
- Fits all connections in the programs 14, 15 and 15A in the respective size

Part no.	plug AD	for hose	L1	L2	D1	NW	g/piece
621-0402	6	OD4 (4/2)	31	15,5	8,5	2	5
621-0443	6	OD4,3 (4,3/3)	31	15,5	9	3	5
621-0403	6	OD5 (5/3)	34,5	19	10,5	3	7
621-0602	8	OD4 (4/2)	34	15,5	8,5	2	7
621-0643	8	OD4,3 (4,3/3)	34	15,5	9	3	7
621-0603	8	OD5 (5/3)	35,5	17	10,5	3	9
621-0604	8	OD6 (6/4)	38,5	20	11,5	4	10
621-0804	10	OD6 (6/4)	40	18,5	11,5	4	13
621-0806	10	OD8 (8/6)	45	24	14,5	6	18
621-1108	14	OD10 (10/8)	52	23,5	16,5	8	32
621-1106	14	OD8 (8/6)	52,5	24	14,6	6,5	33

Closure plug

- Material brass nickel-plated
- Temperature range -20 to +120 °C
- Working pressure range -0.95 to 16 bar
- Fits all connections in the programs 14, 15 and 15A in the respective size

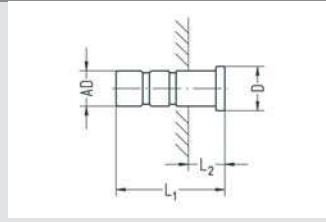

Part no.	plug AD	L1	L2	D	g/piece
623-0200	4	19	7	5,5	2
623-4300	4,3	19	7	5,5	2
623-0300	5	21	7,5	7	4
623-0400	6	21,5	6,5	8	5
623-0600	8	24,5	6,5	10	11
623-0800	10	28	7,5	12	19
623-0900	12	33	7	14	32
623-1100	14	36	7,5	16	47
623-1200	16	38	7,5	17,8	33

O-Ring

- Material FPM
- Temperature range depending on type of coupling (s. coupling)
- Packaging unit 25 pieces

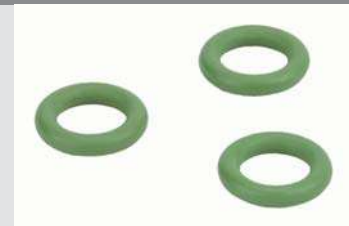

Part no.	Information
9002-02540178-25	suitable for VT1800-xx02
9002-04000200-25	suitable for VT1800-xx04
9002-06000200-25	suitable for VT1800-xx06

ACC

Customised connection solutions



CLIENT

EISELE MULTILINE

Customised connection solutions

Multiple coupling



Coupling with spigot connections, diameter variable. The special coating makes the coupling resistant to the cleaning agent used. Larger coupling diameters available by request.

Multiple coupling



Coupling for 2x fluid and 2x pneumatic. Material: nickel-plated brass. The colour-coded sleeves can be found in our standard product range, EISELE BASICLINE.

Multiple coupling



1810 series coupling, customer specific material: nickel-plated brass.

Y distributor block equipped



The manifold for pneumatics or fluids splits each connection into 2 connections. Available as e.g. 8x, 14x or 20x manifolds.

Angle brackets

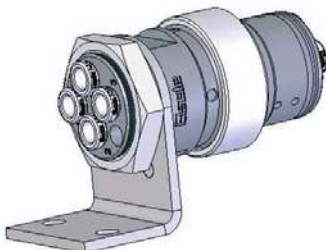

The angle bracket offers a simple mounting option, where the bulkhead fitting cannot be used.

CLIENT

EISELE MULTILINE

Customised connection solutions

Multiple couplings with connections set at an angle

Space-saving customer solution with connections set at an angle.

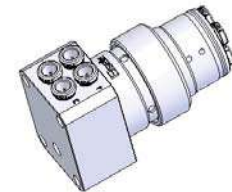

Multiple coupling made of stainless steel

Customer-specific coupling from grade 1.4301 stainless steel. This custom, food grade solution permits semi-automatic coupling at the machine.

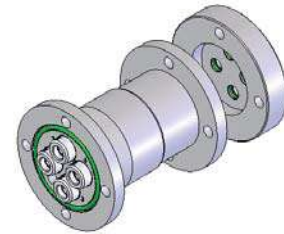

Multiple coupling

Multiple coupling with flange plate

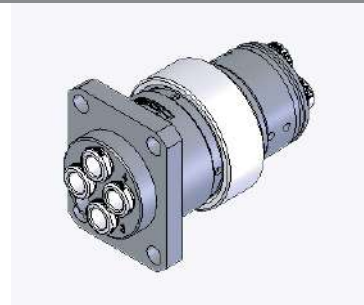

coupling with shut-off

stainless steel coupling with shut-off on both sides



Sealing cap for coupling (plug)

The sealing cap enables the coupling (plug) to be sealed even while open.

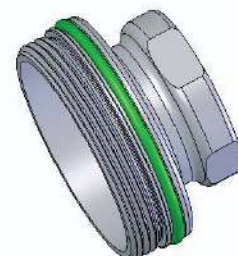

CLIENT

EISELE MULTILINE

Plastic hoses

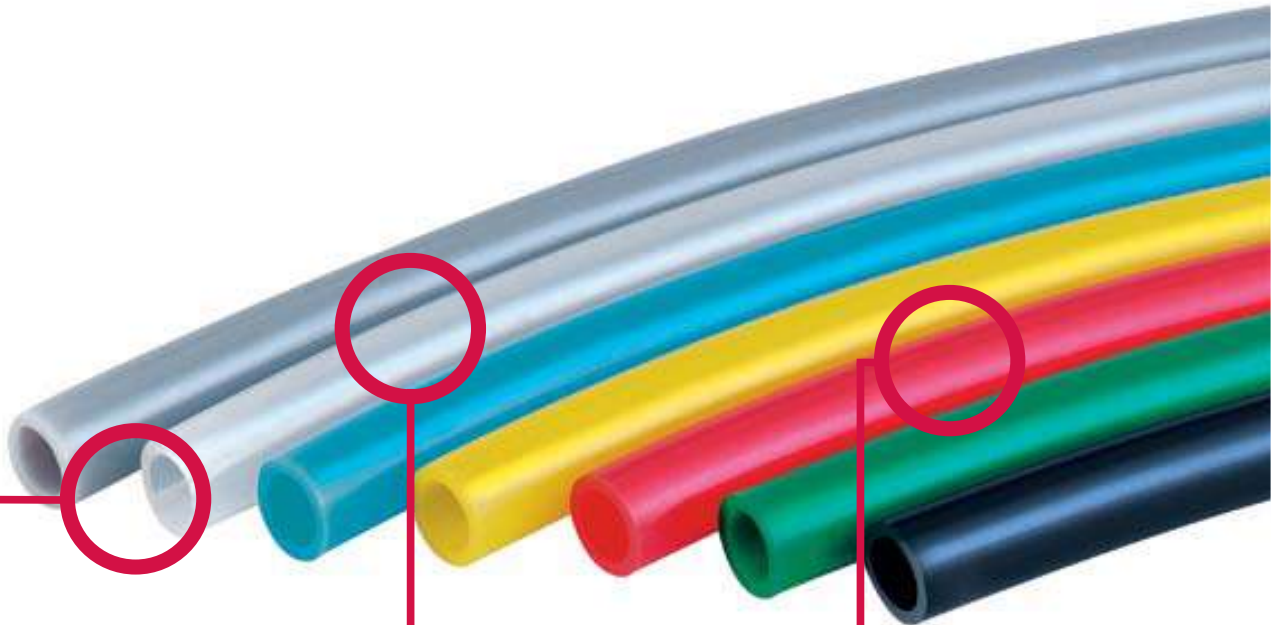

Versatile range of hoses

- Standard compressed-air hoses as well as hoses for special applications and appropriate accessories
- Different hose materials for different application areas

Color and code versions possible

- Hoses can be delivered in many common colors, e.g. to indicate different fluids
- Labeling of hoses for coding possible too

Package solutions of connectors and hoses

- Secure combinations of EISELE connectors and their matching hoses
- Through limited tolerances also very suitable for applications with a high demand on freedom of leakage

On request we also offer hose solutions in other colors, sizes and materials.

Compressed-air hose PE

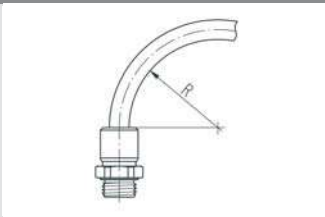

- Made of polyethylene (PE)
- Color black (red, blue, green, yellow, natural, brown, orange and grey: specify when placing order; subject to extra charge)
- External calibration; for use with Eisele plug connectors
- Temperature range -10 to +40 °C
- Free of plasticizer and halogen

Part no.	Outside Ø / Inside Ø	Maximum allowable working pressure at 23 °C (reference value)	min. allowable bend radius	g/m
99004-0402	4 / 2	20 bar	20	8,7
99004-4303	4,3 / 3	13 bar	20	6,9
99004-0503	5 / 3	15 bar	25	11,6
99004-0604	6 / 4	13 bar	30	14,5
99004-0806	8 / 6	8 bar	40	20,3
99004-1008	10 / 8	6 bar	60	26,0
99004-1209	12 / 9	9 bar	60	45,6
99004-1210	12 / 10	5 bar	85	31,9
99004-1411	14 / 11	8 bar	90	54,3
99004-1512	15 / 12	7 bar	90	58,7
99004-1613	16 / 13	6 bar	90	63,0

Compressed-air hose PA

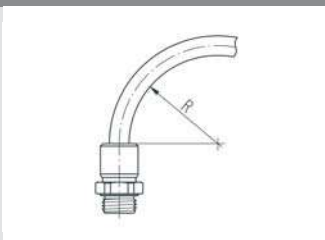

- Made of polyamide (PA)
- Color black (red, blue, green, yellow, natural, brown, orange and grey: specify when placing order; subject to extra charge)
- External calibration; for use with Eisele plug connectors
- Temperature range -60 to +100 °C
- Operating pressure = burst pressure: safety (common factor 2 to 3)
- Suitable for vacuum
- Free of PWIS and halogen

Part no.	Outside Ø / Inside Ø	Minimum burst pressure at 20°C	Minimum burst pressure at 60°C	min. allowable bend radius	g/m
99005-0402	4 / 2	145 bar	82 bar	20	9,7
99005-4303	4,3 / 3	76 bar	43 bar	20	7,7
99005-0503	5 / 3	112 bar	64 bar	25	12,9
99005-0504	5 / 4	-	-	-	-
99005-0604	6 / 4	89 bar	51 bar	30	16,2
99005-0806	8 / 6	63 bar	36 bar	40	22,7
99005-0906	9 / 6	89 bar	51 bar	45	36,1
99005-1008	10 / 8	49,5 bar	28 bar	60	29,1
99005-1209	12 / 9	63 bar	36 bar	60	51,0
99005-1210	12 / 10	39,5 bar	22,5 bar	85	35,6
99005-1411	14 / 11	53 bar	30 bar	80	60,7
99005-1512	15 / 12	49,5 bar	28 bar	90	65,5
99005-1613	16 / 13	46 bar	26 bar	90	70,4

Compressed-air hose PU

- Made of polyester-polyurethane (PU)
- Color black (red, blue, green, yellow, natural, brown, orange and grey: specify when placing order; subject to extra charge)
- External calibration; for use with Eisele plug connectors
- Temperature range -35 to +70 °C
- Operating pressure = burst pressure: safety (common factor 2 to 3)
- Free of plasticizers, PWIS, copper and PTFE
- Impervious to buckling and drag chain compliant
- Suitable for vacuum

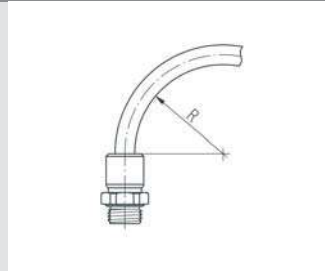

Part no.	Outside Ø / Inside Ø	Minimum burst pressure at 20°C	Minimum burst pressure at 60°C	min. allowable bend radius	g/m
99003-0402	4 / 2,3	45 bar	24 bar	8	10
99003-0425	4 / 2,6	39 bar	23 bar	8	9,0
99003-4303	4,3 / 2,9	36 bar	22 bar	10	11
99003-0503	5 / 3,1	45 bar	24 bar	11	15,0
99003-0604	6 / 3,9	36 bar	23 bar	14	20,0
99003-0806	8 / 5,7	32 bar	20 bar	20	30,0
99003-1008	10 / 7,5	28 bar	16 bar	37,5	44,0
99003-1208	12 / 8	42 bar	26 bar	23	79,0
99003-1209	12 / 9	29 bar	17 bar	48	63
99003-1410	14 / 10	33 bar	20 bar	46	95,0
99003-1411	14 / 11	23 bar	15 bar	60	90,0
99003-1611	16 / 11	32 bar	21 bar	43	132,0

Compressed-air hose PU-H

- Made of polyether-polyurethane (PU-H)
- Color imbued: black, blue
- External calibration; for use with Eisele plug connectors
- Temperature range -35 to +70 °C
- Operating pressure = burst pressure: Safety (common factor 2 to 3)
- Free of halogen, plasticizers, PWIS, copper and PTFE
- Impervious to buckling and drag chain compliant
- Resistant to UV, hydrolysis and microbes
- FDA compliant according to 21 CFR 177.2600
- Suitable for vacuum

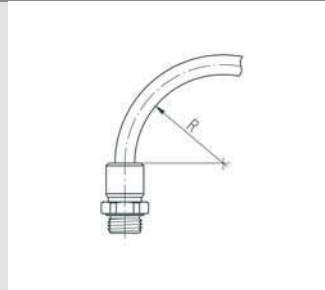

Part no.	Outside Ø / Inside Ø	Minimum burst pressure at 20°C	Minimum burst pressure at 60°C	min. allowable bend radius	g/m
99150-0425	4 / 2,5	34 bar	18 bar	6	8,5
99150-0604	6 / 4	33 bar	18 bar	10	18,3
99150-0806	8 / 6	30 bar	18 bar	20	28,7
99150-1007	10 / 7	30 bar	18 bar	25	46,5
99150-1208	12 / 8	33 bar	18 bar	23	72,9
99150-1611	16 / 11	31 bar	18 bar	38	123,0
99150-2014	20 / 14	ca. 30 bar	ca. 15 bar	-	ca. 187

Compressed-air hose PU-H translucent

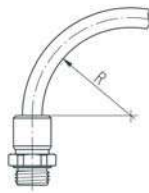

- Made of polyether-polyurethane (PU-H)
- Color translucent: natural, red, blue
- External calibration; for use with Eisele plug connectors
- Temperature range -35 to +70 °C
- Operating pressure = burst pressure: Safety (common factor 2 to 3)
- Free of halogen, plasticizers, PWIS, copper and PTFE
- Impervious to buckling and drag chain compliant
- Resistant to hydrolysis and microbes
- FDA compliant according to 21 CFR 177.2600
- Suitable for vacuum

Part no.	Outside Ø / Inside Ø	Minimum burst pressure at 20°C	Minimum burst pressure at 60°C	min. allowable bend radius	g/m
99151-0425	4 / 2,5	34 bar	18 bar	6	8,5
99151-0604	6 / 4	33 bar	18 bar	10	18,3
99151-0806	8 / 6	30 bar	18 bar	20	28,7
99151-1007	10 / 7	30 bar	18 bar	25	46,5
99151-1208	12 / 8	33 bar	18 bar	23	72,9
99151-1611	16 / 11	31 bar	18 bar	38	123,0
99151-2014	20 / 14	ca. 30 bar	ca. 15 bar	-	ca. 187

Compressed-air hose PTFE

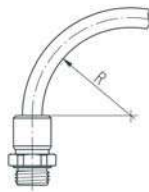

- Made of polytetrafluoroethylene (PTFE, Teflon)
- Color natural
- External calibration; for use with Eisele plug connectors
- Temperature range -190 to +260 °C
- Operating pressure = burst pressure: safety (common factor 2 to 3)
- Free of plasticizers, PWIS, copper and PTFE
- Resistant to UV and solvents
- FDA compliant according to 21 CFR 177.2600
- Flame-retardant according to UL94 V0 to V2

Part no.	Outside Ø / Inside Ø	Minimum burst pressure at 20°C	Minimum burst pressure at 50°C	min. allowable bend radius	g/m
99001-0402	4 / 2	80 bar	52 bar	16	20,3
99001-4303	4,3 / 3	36 bar	21 bar	35	16,1
99001-0503	5 / 3	60 bar	41,5 bar	25	27,1
99001-0604	6 / 4	48 bar	31 bar	35	33,8
99001-0806	8 / 6	36 bar	23,5 bar	65	47,3
99001-0906	9 / 6	48 bar	31 bar	55	76,0
99001-1008	10 / 8	28 bar	18 bar	100	60,8
99001-1209	12 / 9	40 bar	18 bar	100	106,4
99001-1411	14 / 11	28 bar	18 bar	140	126,7

Compressed-air hose FEP

- Made of fluorinated ethylene-propylene copolymer (FEP)
- Color crystal clear
- External calibration; for use with Eisele plug connectors
- Temperature range -35 to +120 °C
- Operating pressure = burst pressure: Safety (common factor 2 to 3)
- Very flexible
- Free of plasticizer, copper and PTFE
- Flame-retardant according to UL94 V0 to V2
- Resistant to UV, hydrolysis and microbes
- Stabilized against thermal degradation and light
- FDA compliant according to 21 CFR 177.2600

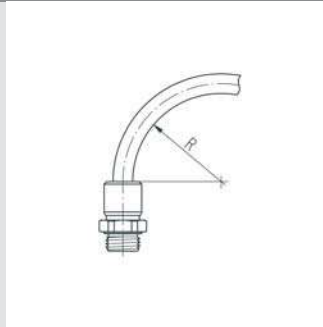

Part no.	Outside Ø / Inside Ø	Minimum burst pressure at 20°C	Minimum burst pressure at 60°C	min. allowable bend radius	g/m
99501-0402	4 / 2	84 bar	70 bar	25	21,0
99501-0503	5 / 3	60 bar	52 bar	35	28,0
99501-0604	6 / 4	50 bar	40 bar	40	35,0
99501-0806	8 / 6	36 bar	29 bar	65	49,0
99501-1008	10 / 8	28 bar	22 bar	100	63,0

Compressed-air hose PFA

- Made of Perfluoro Alkoxyalkane (PFA)
- Color natural
- External calibration; for use with Eisele plug connectors
- Temperature range -20 to +150 °C (at zero pressure -70 to +260°C)
- Operating pressure = burst pressure: Safety (common factor 2 to 3)
- Free of plasticizer and PWIS
- Resistant to UV, hydrolysis, microbes and solvents
- Stable against thermal degradation
- Resistant to weld spatter
- FDA compliant according to 21 CFR 177.2600

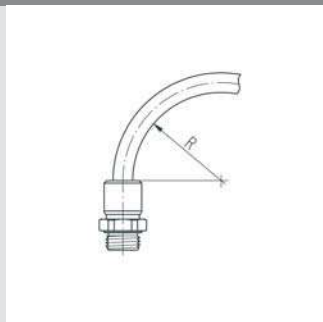

Part no.	Outside Ø / Inside Ø	Minimum burst pressure at 20°C	Minimum burst pressure at 60°C	min. allowable bend radius	g/m
99221-0403	4 / 3	-	-	-	-
99221-0425	4 / 2,5	44 bar	33 bar	11	12,0
99221-0604	6 / 4	60 bar	39 bar	12	34,0
99221-0806	8 / 6	44 bar	33 bar	25	49,0
99221-1007	10 / 7	53 bar	37 bar	22	87,0
99221-1209	12 / 9	50 bar	37 bar	29	125,0
99221-1210	12 / 10	-	-	-	-

Eisele ProWeld hose

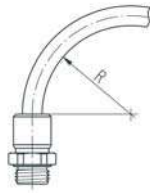

- Made of polyether-polyurethane
- Color black (red, blue, green, yellow, white)
- External calibration; for use with Eisele plug connectors
- Operating temperature -35 to +75 °C
- Operating pressure = burst pressure: safety (common factor 2 to 3)
- Suitable for compressed air, water
- Free of plasticizers, PWIS, halogen, copper and PTFE
- Impervious to buckling and drag chain compliant
- Resistant to UV, hydrolysis and microbes
- Flame-retardant according to UL94 V0 to V2
- Suitable for employment in welding
- Suitable for vacuum

Part no.	Outside Ø / Inside Ø	Minimum burst pressure at 20°C	Minimum burst pressure at 60°C	min. allowable bend radius	g/m
99118-0302	3 / 2	-	-	-	-
99118-0402	4 / 2	57 bar	40 bar	6,5	12,2
99118-0603	6 / 3	57 bar	40 bar	8,5	27,5
99118-0604	6 / 4	40 bar	22 bar	12	22
99118-0804	8 / 4	63 bar	37 bar	8	48,3
99118-0855	8 / 5,5	34 bar	18 bar	18	32,5
99118-1006	10 / 6	49 bar	28 bar	15	64,5
99118-1208	12 / 8	34 bar	21 bar	24	80,8
99118-1410	14 / 10	33 bar	18 bar	38	97,8
99118-1611	16 / 11	37 bar	19 bar	44	136,9
99118-2014	20 / 14	ca. 35 bar	ca. 16 bar	-	-

Hose cutter



- For compressed-air hoses with outer-Ø 14
- Material plastic black / steel
- Packaging unit 1 piece

Part no.		g/piece
99605-0014	Hose cutter for outer diameter up to 14	30
99605-00149	Spare blade for outer diameter up to 14	1

Hose cutter



- For compressed-air hoses with outer-Ø 22
- Material zinc die-casting / steel
- Packaging unit 1 piece

Part no.		g/piece
99606-0022	Hose cutter for outer diameter up to 22 (with bag)	240
99606-00229	Spare blade for outer diameter up to 22	2

Type designation	Page
C	
Closure plug	29
Compressed-air hose FEP	39
Compressed-air hose PA	36
Compressed-air hose PE	36
Compressed-air hose PTFE	38
Compressed-air hose PU	37
E	
Eisele ProWeld hose.....	40
Electropneumatic multiple coupling - Series 1870.....	23
Electropneumatic multiple coupling - Series 1871.....	23
Electropneumatic multiple coupling, vacuum version - Series 1870	23
Electropneumatic multiple coupling, vacuum version - Series 1871	23
H	
Hose cutter.....	40
O	
O-Ring	29
P	
Plastic hose PFA	39
Plastic hose PU-H	37
Plastic hose PU-H translucent	38
R	
Reducing plug	28

Article No.	Page	Article No.	Page	Article No.	Page
VT1800-1206	7	VT1811-100400	11	VT1811-040610	13
VT1800-1204	7	VT1811-120400	11	VT1811-060610	13
VT1800-1202	7	VT1811-040600	11	VT1811-080610	13
VT1800-1006	7	VT1811-060600	11	VT1811-04021001	13-14
VT1800-1004	7	VT1811-080600	11	VT1811-06021001	13-14
VT1800-1002	7	VT1811-04020001	11-12,15	VT1811-08021001	13-14
VT1800-0806	7	VT1811-06020001	11-12,15	VT1811-10021001	13-14
VT1800-0804	7	VT1811-08020001	11-12,15	VT1811-12021001	13-14
VT1800-0802	7	VT1811-10020001	11-12,15	VT1811-04041001	13-14
VT1800-0606	7	VT1811-12020001	11-12,15	VT1811-06041001	13-14
VT1800-0604	7	VT1811-04040001	11-12,15	VT1811-08041001	13-14
VT1800-0602	7	VT1811-06040001	11-12,15	VT1811-10041001	13-14
VT1800-0406	7	VT1811-08040001	11-12,15	VT1811-12041001	13-14
VT1800-0404	7	VT1811-10040001	11-12,15	VT1811-04061001	13-14
VT1800-0402	7	VT1811-12040001	11-12,15	VT1811-06061001	13-14
VT1800-120601	7	VT1811-04060001	11-12,15	VT1811-08061001	13-14
VT1800-120401	7	VT1811-06060001	11-12,15	VT1811-040211	14
VT1800-120201	7	VT1811-08060001	11-12,15	VT1811-060211	14
VT1800-100601	7	VT1811-04020002	11,13,16	VT1811-080211	14
VT1800-100401	7	VT1811-06020002	11,13,16	VT1811-100211	14
VT1800-100201	7	VT1811-08020002	11,13,16	VT1811-120211	14
VT1800-080601	7	VT1811-10020002	11,13,16	VT1811-040411	14
VT1800-080401	7	VT1811-12020002	11,13,16	VT1811-060411	14
VT1800-080201	7	VT1811-04040002	11,13,16	VT1811-080411	14
VT1800-060601	7	VT1811-06040002	11,13,16	VT1811-100411	14
VT1800-060401	7	VT1811-08040002	11,13,16	VT1811-120411	14
VT1800-060201	7	VT1811-10040002	11,13,16	VT1811-040611	14
VT1800-040601	7	VT1811-12040002	11,13,16	VT1811-060611	14
VT1800-040401	7	VT1811-04060002	11,13,16	VT1811-080611	14
VT1800-040201	7	VT1811-06060002	11,13,16	VT1811-040202	15
VT1800-120602	7	VT1811-08060002	11,13,16	VT1811-060202	15
VT1800-120402	7	VT1811-040201	12	VT1811-080202	15
VT1800-120202	7	VT1811-060201	12	VT1811-100202	15
VT1800-100602	7	VT1811-080201	12	VT1811-120202	15
VT1800-100402	7	VT1811-100201	12	VT1811-040402	15
VT1800-100202	7	VT1811-120201	12	VT1811-060402	15
VT1800-080602	7	VT1811-040401	12	VT1811-080402	15
VT1800-080402	7	VT1811-060401	12	VT1811-100402	15
VT1800-080202	7	VT1811-080401	12	VT1811-120402	15
VT1800-060602	7	VT1811-100401	12	VT1811-040602	15
VT1800-060402	7	VT1811-120401	12	VT1811-060602	15
VT1800-060202	7	VT1811-040601	12	VT1811-080602	15
VT1800-040602	7	VT1811-060601	12	VT1811-04020202	15,17
VT1800-040402	7	VT1811-080601	12	VT1811-06020202	15,17
VT1800-040202	7	VT1811-04020102	12,14	VT1811-08020202	15,17
VT1800-990123	26	VT1811-06020102	12,14	VT1811-10020202	15,17
VT1800-990126	26	VT1811-08020102	12,14	VT1811-12020202	15,17
VT1800-990129	26	VT1811-10020102	12,14	VT1811-04040202	15,17
VT1800-990130	26	VT1811-12020102	12,14	VT1811-06040202	15,17
VT1800-990134	26	VT1811-04040102	12,14	VT1811-08040202	15,17
VT1800-990136	26	VT1811-06040102	12,14	VT1811-10040202	15,17
VT1800-990137	26	VT1811-08040102	12,14	VT1811-12040202	15,17
VT1800-990140	26	VT1811-10040102	12,14	VT1811-04060202	15,17
VT1800-990142	26	VT1811-12040102	12,14	VT1811-06060202	15,17
VT1800-990146	26	VT1811-04060102	12,14	VT1811-08060202	15,17
VT1800-990148	26	VT1811-06060102	12,14	VT1811-040220	16
VT1800-990150	26	VT1811-08060102	12,14	VT1811-060220	16
VT1800-990155	26	VT1811-040210	13	VT1811-080220	16
VT1800-990158	26	VT1811-060210	13	VT1811-100220	16
VT1811-040200	11	VT1811-080210	13	VT1811-120220	16
VT1811-060200	11	VT1811-100210	13	VT1811-040420	16
VT1811-080200	11	VT1811-120210	13	VT1811-060420	16
VT1811-100200	11	VT1811-040410	13	VT1811-080420	16
VT1811-120200	11	VT1811-060410	13	VT1811-100420	16
VT1811-040400	11	VT1811-080410	13	VT1811-120420	16
VT1811-060400	11	VT1811-100410	13	VT1811-040620	16
VT1811-080400	11	VT1811-120410	13	VT1811-060620	16

Article No.	Page	Article No.	Page	Article No.	Page
VT1811-080620	16	821-0206	28	99005-0906	36
VT1811-04022001	16-17	821-0406	28	99005-1209	36
VT1811-06022001	16-17	821-0908	28	99005-1210	36
VT1811-08022001	16-17	1800-97243	27	99005-1411	36
VT1811-10022001	16-17	1800-97257	27	99005-1512	36
VT1811-12022001	16-17	1800-97300	27	99005-1613	36
VT1811-04042001	16-17	1800-97320	27	99118-0302	40
VT1811-06042001	16-17	1800-97336	27	99118-0402	40
VT1811-08042001	16-17	1800-97345	27	99118-0603	40
VT1811-10042001	16-17	1800-97355	27	99118-0804	40
VT1811-12042001	16-17	1800-97379	27	99118-0855	40
VT1811-04062001	16-17	1800-97385	27	99118-1006	40
VT1811-06062001	16-17	1800-97413	27	99118-1208	40
VT1811-08062001	16-17	1800-97439	27	99118-1410	40
VT1811-040222	17	1800-97445	27	99118-1611	40
VT1811-060222	17	1800-97479	27	99118-0604	40
VT1811-080222	17	1800-97498	27	99118-2014	40
VT1811-100222	17	1800-97505	27	99150-0425	37
VT1811-120222	17	1800-97555	27	99150-0604	37
VT1811-040422	17	1800-97570	27	99150-0806	37
VT1811-060422	17	1800-97605	27	99150-1007	37
VT1811-080422	17	1800-97613	27	99150-1208	37
VT1811-100422	17	1811-9810	26	99150-1611	37
VT1811-120422	17	1811-9820	26	99150-2014	37
VT1811-040622	17	1811-9830	26	99151-0425	38
VT1811-060622	17	1811-9840	26	99151-0604	38
VT1811-080622	17	1811-9814	26	99151-0806	38
VT1870-060626C-001	23	1811-9800	26	99151-1007	38
VT1870-060626C-002	23	99001-0402	38	99151-1208	38
VT1870-060626C-003	23	99001-4303	38	99151-1611	38
VT1870-060626C-004	23	99001-0503	38	99151-2014	38
VT1870-060626C-005	23	99001-0604	38	99221-0425	39
VT1870-060626C-006	23	99001-0806	38	99221-0604	39
VT1871-060610C-001	23	99001-0906	38	99221-0806	39
VT1871-060610C-002	23	99001-1008	38	99221-1007	39
VT1871-060610C-003	23	99001-1209	38	99221-1209	39
VT1871-060610C-004	23	99001-1411	38	99221-0403	39
VT1871-060610C-005	23	99003-0402	37	99221-1210	39
VT1871-060610C-006	23	99003-0425	37	99501-0402	39
621-0402	28	99003-4303	37	99501-0503	39
621-0403	28	99003-0503	37	99501-0604	39
621-0443	28	99003-0604	37	99501-0806	39
621-0602	28	99003-0806	37	99501-1008	39
621-0603	28	99003-1008	37	99605-0014	40
621-0604	28	99003-1209	37	99605-00149	40
621-0643	28	99003-1411	37	99606-0022	40
621-0804	28	99003-1611	37	99606-00229	40
621-0806	28	99003-1208	37		
621-1106	28	99003-1410	37		
621-1108	28	99004-0402	36		
623-0200	29	99004-4303	36		
623-0300	29	99004-0503	36		
623-0400	29	99004-0604	36		
623-0600	29	99004-0806	36		
623-0800	29	99004-1008	36		
623-0900	29	99004-1210	36		
623-1100	29	99004-1209	36		
623-4300	29	99004-1411	36		
623-1200	29	99004-1512	36		
821-0402	28	99004-1613	36		
821-0602	28	99005-0402	36		
821-0604	28	99005-4303	36		
821-0806	28	99005-0503	36		
821-0906	28	99005-0504	36		
821-1108	28	99005-0604	36		
821-1109	28	99005-0806	36		
821-0204	28	99005-1008	36		

§ 1 General

(1) These conditions of sale shall apply to agreements that are concluded between Eisele Pneumatics GmbH & Co. KG, Waiblingen (hereinafter "Eisele") and its business customers (hereinafter "Customer"), insofar as these conditions of sale are validly incorporated. General terms and conditions of the Customer that contradict or deviate from these conditions of sale shall not form part of the agreement unless Eisele expressly consents in writing to the application of such general terms and conditions. These conditions of sale shall also apply if we unconditionally perform deliveries to the Customer while being aware of general terms and conditions of the Customer that contradict or deviate from these conditions of sale.

(2) Any arrangements reached between Eisele and the Customer with respect to an agreement shall be in writing. If the Customer does not agree with the application of these conditions of sale, it shall notify Eisele hereof without undue delay.

(3) These conditions of sale shall only apply vis-à-vis entrepreneurs within the meaning of sec.310(1) German Civil Code. Within the scope of ongoing business relations our conditions of sale shall also apply to future deliveries and services unless they are expressly agreed on anew.

§ 2 Offers; order acceptance

(1) Unless the offer expressly provides otherwise, the offers from Eisele shall be without obligation and exclusively understood as an invitation to submit an offer. Any agreements between Eisele and the Customer shall require written order confirmation by Eisele vis-à-vis the Customer.

(2) Descriptions and price information in catalogs, price lists, circulars, brochures or the like shall not be binding and shall merely serve to provide general information to prospective customers about the services offered by Eisele, unless we expressly confirmed this information when concluding an agreement. This also applies, in particular, to illustrations as well as to details regarding the size and weight of our products and services.

§ 3 Delivery periods, partial deliveries

(1) Any agreed delivery period shall begin, unless otherwise specified, on the day on which the order confirmation is received by the Customer.

(2) Eisele's compliance with the delivery obligation requires the timely and proper fulfillment of the Customer's cooperation obligations. Eisele reserves the right to plead non-performance.

(3) Eisele shall have the right to withhold delivery from the Customer if Eisele has a payable claim against the Customer.

(4) Eisele shall have the right to make partial deliveries to an extent that is reasonable for the Customer.

(5) Unforeseeable events of force majeure such as, in particular, war, riot, strike, lockout, measures by public authorities and resulting limitations of the capacity of pre-suppliers shall release Eisele from its delivery obligation for the duration of such events and for an additional two weeks. Should any of the aforementioned events last more than 6 weeks, both parties shall have the right to rescind the agreement if it becomes unreasonable for Eisele to render services.

§ 4 Transport, shipping, insurance

Shipments shall be made ex works from the Waiblingen site (Incoterms 2010). Should this be deviated from, the customer shall nevertheless bear the risk associated with the delivery unless expressly otherwise specified.

§ 5 Price

Prices shall be set in euros.

§ 6 Payments

(1) Invoices shall become payable immediately following receipt of the goods without a cash discount deduction, unless otherwise explicitly agreed.

(2) If Eisele accepts payment by bill of exchange, this shall be done on account of performance only. All bill of exchange expenses shall be borne by the Customer; it shall not be entitled to a cash discount deduction.

(3) As long as the Customer is not merely in arrears by an insignificant amount, Eisele can make the performance of services to be rendered contingent on prepayment by the Customer. Should the prepayment not be made within a reasonable time limit, Eisele shall have the right to cancel all orders not yet filled if the consideration has not been paid by the customer by the time at which the time limit expires.

§ 7 Reservation of title

(1) Eisele reserves title to the goods until all of Eisele's claims against the Customer that have already arisen have been paid in full. In this connection the legal grounds on which Eisele's claims against the Customer are based are irrelevant. This also includes, in particular, balance claims from current account. Claims for which a bill of exchange is negotiated or a check is issued to Eisele shall not be deemed satisfied until the bill of exchange or check is paid or cashed.

(2) The Customer shall, without undue delay, inform Eisele in writing of intervention by third parties such as, for example, attachment or execution by means of which rights of Eisele (in particular, Eisele's reservation of title) are impaired.

(3) If the third party is not able to reimburse Eisele for the in-court and out-of-court costs of an action pursuant to sec. 771 German Code of Civil Procedure, the Customer shall be liable for the resulting shortfall.

(4) The processing or alteration of goods by the Customer shall always be carried out on behalf of Eisele. If the product is processed with other objects not belonging to Eisele, Eisele shall acquire joint ownership of the new thing based on the ratio of the value of the goods to the other processed items at the time of the processing. Otherwise, the thing arising from the processing shall be subject to the same provisions as the goods for which title is reserved.

(5) The Customer may resell the reserved goods only within the scope of its regular business operations. It shall be entitled and authorized to resell the reserved goods provided that the claims it accrues against its purchasers or third parties due to the resale, transfer to Eisele. The claims of the Customer arising from the resale of the reserved goods are now assigned to Eisele. Eisele accepts such assignment. The Customer shall not be entitled to otherwise dispose of the reserved goods; in particular, it may not pledge or assign the reserved goods by way of security. The Customer's right to sell the reserved goods shall expire in the event of a considerable worsening of the Customer's financial situation (insolvency, threatening insolvency, opening of insolvency proceedings) if the Customer ceases making payments from the proceeds collected and/or gets into arrears.

(6) The Customer shall be authorized to collect the assigned claims until revocation by Eisele. Eisele shall have the right to revoke the collection authorization at any time. The Customer shall not have the right to assign the claim to third parties. Eisele shall not make any use of the right of revocation as long as the Customer duly complies with its payment obligations. At Eisele's request, the Customer shall inform its purchasers of the assignment to Eisele and provide Eisele with the necessary information and documents for collecting the claim. With respect to the expiry of the Customer's collection authorization, para. 5 shall apply mutatis mutandis.

(7) Eisele undertakes, upon the Customer's request, to release the security to which it is entitled in accordance with the above

provisions insofar as its realizable value exceeds the claims to be secured by more than 10%. Eisele shall have the right to decide which security is released.

§ 8 Rights

Eisele shall reserve its copyrights in illustrations, drawings, calculations, drafts and other documents that were prepared by Eisele. This shall apply, in particular, to written documents that are designated as "confidential". The Customer must receive Eisele's express written consent before passing on such documents to third parties.

§ 9 Guarantee, inspection

(1) Insignificant discrepancies, in particular technical improvements or product enhancements, shall not constitute defects within the meaning of sec. 434 German Civil Code.

(2) Furthermore, it shall not constitute a defect where the products are not free from anti-wetting substances, in particular silicone or light lubrication. Although the products are silicone-free when they leave production, it cannot be guaranteed that the products will be absolutely free from silicone or entirely free from other anti-wetting substances, since Eisele's suppliers (packaging suppliers) cannot issue any corresponding guarantees.

(3) The goods delivered within the scope of commercial transactions shall be inspected by the Customer without undue delay and, if a defect is detected, this shall be notified in writing, without undue delay, no later than within two weeks after receiving the goods (patent defect) or after discovery of the defect (latent defect).

(4) If it can be demonstrated that the goods have a defect at the time of the transfer of risk, the Customer can demand subsequent performance. Eisele can decide whether to repair or replace the defective goods. The Customer shall have the right to a reduction or to rescind the agreement if subsequent performance fails. This is the case if two replacement deliveries were also defective or two repair attempts were unsuccessful. Should goods that are allegedly defective, but actually fault-free, be returned, Eisele shall be at liberty to charge the Customer a reasonable amount to cover expenses incurred by Eisele in this connection, in particular for the repeated inspection of the goods.

(5) Warranty claims of the Customer based on defects shall become statute-barred 12 months after delivery of the goods. This shall not apply with respect to items that, due to their customary manner of use, were used for a building and caused the defectiveness of that building; in this case the claim shall only become statute-barred after five years. There shall be no warranty claim for downgraded goods, special items, waste and goods that are not new. There shall be no claims to reduction or the exercise of a right of rescission if the claim to subsequent performance has become statute-barred.

§ 10 Liability

(1) Eisele shall not be liable for direct or indirect damage (for example, due to an operational interruption or lost profits of the Customer), irrespective of the legal grounds therefor.

(2) The above exclusion of liability shall not apply:

- (i) in the event of willful or grossly negligent breaches of duty by the governing bodies, employees or vicarious agents of Eisele;
- (ii) in the event of an injury to life, limb or health;
- (iii) in the event of a breach of material contractual duties. In the latter case, liability of Eisele shall, however, be limited to damage typically foreseeable upon conclusion of the agreement. For damage that could not be foreseen by Eisele, liability shall be limited to the value of the order.

(3) The above restrictions and limitations shall not be applied to liability provisions that are required by law, such as, for example, those of the Product Liability Act.

§ 11 Final provisions, applicable law, jurisdiction

(1) Agreements between Eisele and the Customer shall be exclusively governed by German law to the exclusion of the United Nations Convention on Contracts for the International Sale of Goods (CISG) and private international law.

(2) Waiblingen shall be the sole place of jurisdiction for all disputes arising from or in connection with the business relations between Eisele and the Customer, provided that the Customer is a dealer. The place of jurisdiction shall also apply to actions pertaining to checks or bills of exchange.

(3) Should a provision of these conditions of sale be or become invalid or impracticable, this shall not affect the validity of the remaining conditions of sale. Eisele and the Customer undertake, in such a case, to replace the invalid or impractical provision with a valid or practicable provision that comes as close as possible to the spirit and purpose of the provision to be replaced.

(4) Should these conditions of sale contain an unintended omission, this shall be filled with a provision that Eisele and the Customer would have agreed on had they considered the need for a provision governing the respective issue.

Waiblingen, August 2011

* * *

CUSTOMISED CONNECTION SOLUTIONS

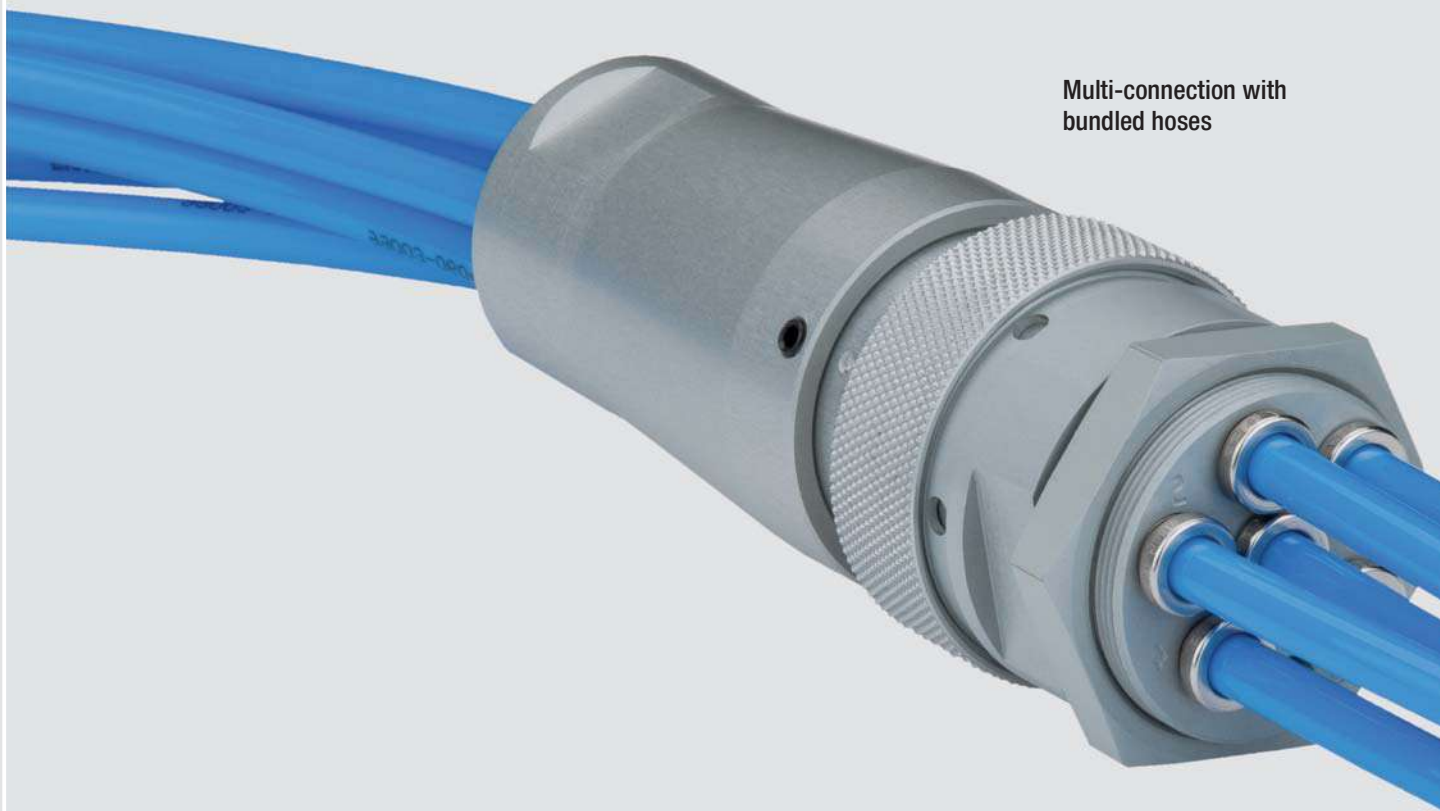

Multi-connection with bundled hoses

We master your individual specifications. The EISELE **CLIENTLINE** was created to deliver customized connection solutions even for the most challenging individual specifications. Every new **CLIENTLINE** product is unique, based on our 40 years of experience with connections in many industrial sectors.

The challenges we tackle with EISELE **CLIENTLINE** solutions are a welcome source of inspiration – strengthening our company’s innovation power.

Thanks to its cross-sector competence, EISELE has developed compelling connection solutions for a large number of industries:



1 Customers in the **pharmaceutical and medical technology sectors** demand extreme precision combined with maximum cleanliness of the tubing system.

2 Hygiene and rugged construction play an important role in the **food industry**. The connections used here are mainly made of stainless steel.

3 When complex machines have to be fed by a **central lubrication system**, the media have to be very precisely dosed, and the connections and tubing need long lifetimes.

4 The connection technology for **paint spraying systems** needs dead-space-free tubing systems, and components capable of fast and residue-free cleaning.

5 An important factor for tubing technology in **welding systems** is that the connections and the hoses are flame-proof and resistant to weld spatter.

6 If the complete **pipng system** is used as a **pressure reservoir** in compressed air systems, all the components must be pressure-tight and leak-proof.



MANY SOLUTIONS FROM ONE MODULAR

EISELE BASICLINE

Standard components for pneumatics

EISELE **BASICLINE** gives our customers a wide choice of our stock of approx. 3,500 standardized connection components. We can therefore deliver at very short notice a complete range of screw joints, plug connectors, matching hoses and a wide spectrum of accessories.

Many of these EISELE products are authorized for use by the major automotive manufacturers like Audi, Daimler or Volkswagen.

EISELE INOXLINE

Stainless steel connection solutions

Stainless steel connections are frequently called for systems in the food and pharmaceutical sectors – and they are essential for many applications.

Based on the design of our tried-and-tested standard components, we supply a broad range of media-resistant connections made of corrosion-proof and acid-resistant stainless steel. The connections are equally tough enough for aggressive production environments and cleaning products.



BASIC

FROM STANDARDIZED TO HIGHLY

EISELE LIQUIDLINE

Connections for cooling water

The through-flow-optimized connections in the EISELE **LIQUIDLINE** are perfectly suited for applications with closed cooling-water cycles.

All parts in contact with media are made of a brass alloy not susceptible to dezincification. When combined with the hoses, connections with FPM seals are resistant to many media as well as high temperatures.

EISELE MULTILINE

Multiple couplings for multiple media connections

From plant installations, to maintenance and repair, the couplings in the EISELE **MULTILINE** join separate components or complete modules in a safe, efficient and space-saving way with the simple, centralized, plug and screw joint connectors. In machines with combined air and liquid inlets, the connections discourage assembly mistakes. They can also be coupled and uncoupled under pressure thanks to the integrated shut-off valves.



INOX



LIQUID



MULTI



Eisele Pneumatics GmbH & Co. KG
Qualitäts-Anschlusskomponenten
für Druckluft, Gase und Flüssigkeiten
Quality connection components for
compressed air, gases, and liquids

Hermann-Hess-Str. 14-16
71332 Waiblingen | Germany

Telephone +49 (0) 7151-1719-0
Fax +49 (0) 7151-1719-17

info@eisele.eu
www.eisele.eu

QUALITY CONNECTION COMPONENTS FOR COMPRESSED AIR, GASES, AND LIQUIDS



BASIC

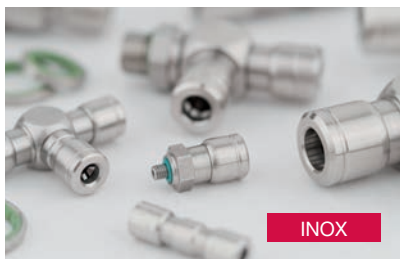

INOX

EISELE **INOXLINE**
Stainless steel connection
solutions



LIQUID

EISELE **LIQUIDLINE**
Connections for cooling water



MULTI

EISELE **MULTILINE**
Multiple couplings for multiple
media connections